

# Appendix 1

## LICENCE FOR A SEXUAL ENTERTAINMENT VENUE

**Licence Number: 19574**

The **LONDON BOROUGH OF TOWER HAMLETS** under provisions of Schedule 3 of the Local Government (Miscellaneous Provisions) Act 1982, in relation to the licensing of sex establishments, as amended by section 27 of the Policing and Crime Act 2009, grants, in accordance to its Licensing Policy:

**Name, (registered) address, telephone number and email (where relevant) of holder of SEV licence:**

(1) Karpal Singh (2) Shamsheer Singh and (3) Manpal Singh

to use premises:

<b>Postal address of premises, or if none, ordnance survey map reference or description</b> The Nags Head Public House 17-19 Whitechapel Road	
<b>Post town</b> London	<b>Post Code</b> E1 1DU
<b>Telephone number</b> [REDACTED]	

as a Sexual Entertainment Venue.

This licence is in force up to: **31<sup>st</sup> May 2016** or during the time that the licensee(s) is/are the occupier of the premises, whichever is the shorter period, or unless sooner surrendered or revoked.

The hours permitted are: **Monday to Saturday from 11:00hrs to 03:00hrs (the following day)**  
**Sunday from 12:00hrs (midday) to 22:30hrs**

<b>The named management responsible for this premises are</b>  Manpal Singh and Shamsheer Singh - Managers Keith Harrington – Relief Manager Alcir Orlandi – Relief Manager
---

This licence is granted subject to conditions as follows:

1. the Standard Conditions of the London Borough of Tower Hamlets made under paragraph 13 of Schedule 3 to the Local Government (Miscellaneous Provisions) Act 1982 as revised on 23<sup>rd</sup> June 2015 and sent to the Licence Holder as part of the Decision Notice dated 17<sup>th</sup> July 2015. It is the duty of the licence holder to be aware of and abide by those conditions.
2. the following additional conditions specific to this Premises:

42. The number of persons to be accommodated in the Premises at any one time shall not exceed 100 persons.

Other requirements or restrictions:

This licence must be prominently and visibly displayed inside the entrance to the Premises.

This licence together with the standard conditions must be available at the Premises at all times.

**Signed by**

**John McCrohan**   
**Trading Standards and Licensing Manager**

**STANDARD CONDITIONS FOR SEXUAL ENTERTAINMENT VENUES**  
**(REVISED 23<sup>RD</sup> JUNE, 2015)**

**Definitions**

In this Licence,

‘approved layout’ means the layout of the Premises shown on the attached plan.

‘authorised officers’ means officers of the Borough Council or of the Police

‘drinks tariff’ means a tariff showing the price of all drinks

‘entertainment tariff’ means a tariff showing the price of all sexual entertainment performances, displays of nudity and services related to the sexual entertainment performance (including charges for admission to any part of the Premises; for hire of rooms, booths or reserved areas; or for the company of performers)

‘nudity’ , ‘display of nudity’ and ‘sexual entertainment’ are references to those terms as defined by section 27 of the Policing and Crime Act 2009.

‘performers’ means persons engaged by or through the Licensee who provide or participate in sexual entertainment

‘premises’ includes land, buildings, stalls, structures or erections, and all forms of vessels or vehicles (including for the avoidance of doubt bicycles, motor vehicles, boats and aircraft). It does not include any private dwelling to which the public is not admitted.

‘the Premises’ means the premises authorised in this Licence as a sexual entertainment venue and shown on the attached plan.

‘public area(s)’ means the area(s) outlined in blue on the attached plan, being the area within the Premises that the public are permitted to enter.

‘the public’ includes customers, guests and visitors to the premises, but excludes performers and those employees or agents of the Licensee lawfully engaged in managing or operating the Premises.

‘sexual entertainment area(s)’ means the area(s) outlined in red on the attached plan, being locations where sexual entertainment is permitted to take place.

‘suggestive advertising content’ means photographs, sculptures, images, tableaux, displays, sounds, spoken words or writing - including graphics, logos or trademarks- that depict, indicate or suggest that sexual entertainment takes place on the Premises

### **General**

1. The Licensee must remain in personal control of the premises at all times that it is trading or nominate in writing an individual over the age of 18 with the authority to direct activities within the Premises.
2. The Licensee shall notify the Council, in writing, of any change in directors, trustees, partners or other persons concerned in the management of the licensed activities within 14 days of such change.
3. The Licensee shall admit authorised officers to the Premises at all reasonable times and at any time when the Premises are providing sexual entertainment. The Licensee shall provide in a timely fashion copies of any documents reasonably required by an authorised officer to prove compliance with this Licence.
4. The Licensee must give written notice to the Council if s/he wishes to surrender the licence.
5. A suitable and sufficient number of door supervisors and trained staff will be employed (based on a risk assessment) when sexual entertainment is offered. Their duties will include monitoring customers to ensure that the Code of Conduct for Performers and the House Rules are being obeyed.
6. The Licensee is to implement a suitable policy for the safety of the performers when they leave the Premises.
7. The Council reserves the right to amend or alter these conditions (provided that such change will not prevent the operators from viably carrying on the business of the Premises) following consultation with the licensees.

## Premises

8. The approved layout of the Premises shall not be altered without prior consent of the Council.
9. The Licensee shall ensure that the interior of the Premises where sexual entertainment is offered shall not be capable of being seen from the outside of the Premises, and that the exterior is maintained with a suitable level of decorum (i.e. that it does not have anything that depicts, indicates or suggests that sexual entertainment takes place on the Premises).
10. Sexual entertainment shall take place only in the designated sexual entertainment areas.
11. No member of the public shall be permitted to go anywhere outside the public areas. The public shall not be permitted access to the performers' changing rooms.
12. Without prejudice to condition 13 below CCTV shall be installed to cover the inside and the outside of the Premises, covering all public areas, including private performance areas and booths, entrances and exits, but excluding the interior of toilets. All cameras must be maintained in working order. All cameras shall continually record whilst the Premises are open to the public and the recorded images shall be kept available for a minimum of 31 days. Recorded images shall be made available to an authorised officer together with facilities for viewing. The recordings for the preceding 2 days shall be made available immediately upon request. Recordings outside this period shall be made available on 24 hours' notice.
13. CCTV cameras shall be installed and maintained at the locations shown on the attached plan, to the reasonable satisfaction of the licensing authority.
14. Members of the public may not enter or remain in the toilet cubicles in the company of any performer. Only one person at a time to enter a toilet cubicle.

## **Advertising**

15. The Licensee shall neither cause nor permit the display of suggestive advertising content which is directed at or may be seen or heard by any person from within the London Borough of Tower Hamlets:

on any public highway, street, waterway or railway;  
in any place of general public use or access; or  
in publicly accessible areas of premises open to the public.

This condition shall apply to prevent suggestive advertising content being displayed on the exterior of the Premises or handed out as flyers on the street. It shall also apply to prevent suggestive advertising content being displayed on or in street furniture; telephone booths; hoardings, billboards, screens or projections; as well as advertising displayed on or within any vehicles located on or near the highway. The Licensee shall not permit any person to tout for business or encourage other persons to visit the Premises whilst on a public highway.

For the avoidance of doubt, this condition shall not be taken to prevent the Licensee from advertising the Premises using suggestive advertising content in media that restrict access to persons over the age of 18 years and would not reasonably be expected to be directed at persons in a public place (for instance, in adult magazines, websites or television channels).

16. All persons engaged or employed to attend to the entrance area or exterior of the Premises must be suitably dressed and conduct themselves so as not to indicate or suggest the availability of sexual entertainment at the Premises.
17. Where the Council has given notice in writing to the Licensee objecting to an advertisement on grounds that it would offend public decency or be likely to encourage or incite crime or disorder, that advertisement shall be removed or not be displayed.

## **Admission to the Premises**

18. No person under the age of 18 years shall be admitted to nor permitted to remain on the Premises when sexual entertainment is being offered, and a clear notice to this effect will be displayed at each entrance to the Premises.

19. Customers who appear to be under the age of 21 must be asked to provide a Pass-scheme approved photographic card, their passport or photographic driving licence to prove their age. Prominent notices must be clearly displayed to this effect at each entrance to the Premises.

#### **House Rules**

20. The Licensee shall prepare House Rules governing the conduct of customers.
21. The House Rules shall be prominently and legibly displayed close to each entrance of the Premises.
22. The House Rules must be made known to customers prior to their admission to the Premises when sexual entertainment is provided
23. Signs must be displayed at appropriate locations advising that any customer attempting to make physical contact with a performer will be asked to leave.
24. No member of the public shall be admitted or allowed to remain at the Premises if they appear to be intoxicated or under the influence of illegal substances.
25. Customers may not be permitted to photograph, film or electronically record any performance.
26. The House Rules must be implemented and effectively enforced at all times when the premises are operating with sexual entertainment.

#### **Performers**

27. Sexual entertainment will be given only by the performers engaged by or through the Licensee and there will be no audience participation in any performances.
28. The Licensee shall keep a record of each performer, including their proper name and any aliases, and their residential address. With each record the Licensee shall keep a copy of a photographic form of identity and proof of address of the performer. With each record the Licensee shall keep a clear copy of an authorised document demonstrating that each Performer and each member of the staff is



entitled to work within the UK. A clear copy of this record shall be kept on the Premises at all times and be made immediately available for inspection by authorised officers.

29. On days when sexual entertainment is provided, the Licensee or their representative shall keep a record of those performers working at the Premises on that day in a daily record. The daily record shall be retained securely for at least 31 days and shall be made immediately available for inspection by authorised officers.

### **Tariffs**

30. The Licensee shall prominently and legibly display the drinks tariff at or by the bar and at the entrance. No charge shall be made nor payment accepted for any drink other than in accordance with the tariff, save for clearly advertised discounts to the tariff.
31. The Licensee shall prominently and legibly display the entertainment tariff in the entrance area and at key locations within the Premises including entrances to any private performance areas and so far as possible at the place(s) at which payment for any performance or service is transacted as marked on the attached plan. No charge shall be made nor payment accepted by the Licensee for any services other than in accordance with the tariff or clearly advertised discounts to the tariff.
32. The Licensee shall so far as reasonably practicable keep such records as are necessary to prove that the sums charged and payments taken are for products or services advertised on the relevant tariff at the amount shown on that tariff. These records must be made available within a reasonable time if requested by an authorised officer.

### **Code of Conduct**

33. The Licensee shall prepare and implement a suitable Code of Conduct for performers.
34. The Licensee shall ensure that each performer signs the Code of Conduct in their proper name, acknowledging that they have read and understood and are prepared to abide by the Code of Conduct, and signed copies be kept on the premises for inspection by authorised officers.

35. During a performance there shall be no intentional physical contact between a performer and the customer other than the transfer of money or token at the beginning, during and at the conclusion of a dance into the hand or a garter worn by the performer. For the avoidance of doubt nothing in this condition shall prevent Performers from acting to prevent, deter or counter any attempts of physical contact by a customer.
36. Without prejudice to standard condition 35 above, at the conclusion of a performance there shall be no intentional physical contact between a performer and the customer, save for a handshake. For the avoidance of doubt kissing is not permitted.
37. The Licensee must not permit gratuities or any other items to be thrown at performers.
38. During a performance there shall be no full body physical contact between performers and they are not to touch each other's breasts or genitalia either with their bodies or with objects. Any performance shall be restricted to dancing and the removal of clothes. There must not be any other form of sexual activity, including but not limited to acts or the simulation of acts of personal stimulation.
39. Performers shall be provided with a changing room to which the public have no access.
40. Performers must remain fully dressed while on the Premises, except while performing in the sexual entertainment areas and in the changing rooms shown on the approved plan. [Without prejudice to this requirement, there is to be no display of nudity in the public areas of the Premises, other than during the course of a performance].
41. Performers must re-dress at the conclusion of a performance.

# Appendix 2

**(The Nags Head Public House)  
17-19 Whitechapel Road  
London  
E1 1DU**

**Licensable Activities authorised by the licence**

Retail sale of alcohol  
Provision of Regulated Entertainment

**See the attached licence for the licence conditions**

**Signed by**

**Jacqueline Randall \_\_\_\_\_  
Acting Licensing Services Manager**

**Date: 7<sup>th</sup> October 2005**

Amended Minor variation 11/11/10



LICENSING ACT 2003

## Part A - Format of premises licence

Premises licence number

14598

### Part 1 - Premises details

**Postal address of premises, or if none, ordnance survey map reference or description**

(The Nags Head Public House)  
17-19 Whitechapel Road  
E1 1DU

**Post town**

London

**Post code**

E1 1DU

**Telephone number**

[REDACTED]

**Where the licence is time limited the dates**

Not applicable

**Licensable activities authorised by the licence**

The sale by retail of alcohol

The provision of regulated entertainment consisting of recorded music, performance of dance, anything of similar nature.

Facilities for making music and dancing and similar nature.

**The times the licence authorises the carrying out of licensable activities**

Monday to Saturday 11 00 hrs to 03 00 hrs the following day  
Sunday 12 00 hrs to 22 30 hrs

**The opening hours of the premises**

From Monday to Saturday from 11 00 hrs until 03 30 hrs the following day  
Sunday 12 00 hrs to 23 00 hrs

**Where the licence authorises supplies of alcohol whether these are on and/ or off supplies**

On and off sales

**Part 2**

**Name, (registered) address, telephone number and email (where relevant) of holder of premises licence**

Karpal Singh and Shamsheer Singh

[Redacted address and contact information]

**Registered number of holder, for example company number, charity number (where applicable)**

Not applicable

**Name, address and telephone number of designated premises supervisor where the premises licence authorises the supply of alcohol**

Karpal Singh

[Redacted address and telephone number]

**Personal licence number and issuing authority of personal licence held by designated premises supervisor where the premises licence authorises for the supply of alcohol**

[Redacted personal licence number and issuing authority]

**Annex 1 - Mandatory conditions**  
**Effective from 6<sup>th</sup> April 2010**

1.

- (1) The responsible person shall take all reasonable steps to ensure that staff on relevant premises do not carry out, arrange or participate in any irresponsible promotions in relation to the premises.
- (2) In this paragraph, an irresponsible promotion means any one or more of the following activities, or substantially similar activities, carried on for the purpose of encouraging the sale or supply of alcohol for consumption on the premises in a manner which carries a significant risk of leading or contributing to crime and disorder, prejudice to public safety, public nuisance, or harm to children—
  - (a) games or other activities which require or encourage, or are designed to require or encourage, individuals to;
    - (i) drink a quantity of alcohol within a time limit (other than to drink alcohol sold or supplied on the premises before the cessation of the period in which the responsible person is authorised to sell or supply alcohol), or
    - (ii) drink as much alcohol as possible (whether within a time limit or otherwise);
  - (b) provision of unlimited or unspecified quantities of alcohol free or for a fixed or discounted fee to the public or to a group defined by a particular characteristic (other than any promotion or discount available to an individual in respect of alcohol for consumption at a table meal, as defined in section 159 of the Act);
  - (c) provision of free or discounted alcohol or any other thing as a prize to encourage or reward the purchase and consumption of alcohol over a period of 24 hours or less;
  - (d) provision of free or discounted alcohol in relation to the viewing on the premises of a sporting event, where that provision is dependent on;
    - (i) the outcome of a race, competition or other event or process, or
    - (ii) the likelihood of anything occurring or not occurring;
  - (e) selling or supplying alcohol in association with promotional posters or flyers on, or in the vicinity of, the premises which can reasonably be considered to condone, encourage or glamorise anti-social behaviour or to refer to the effects of drunkenness in any favourable manner.



2. The responsible person shall ensure that no alcohol is dispensed directly by one person into the mouth of another (other than where that other person is unable to drink without assistance by reason of a disability).
3. The responsible person shall ensure that free tap water is provided on request to customers where it is reasonably available.

**Effective from 10<sup>th</sup> October 2010:**

4.
  - (1) The premises licence holder or club premises certificate holder shall ensure that an age verification policy applies to the premises in relation to the sale or supply of alcohol.
  - (2) The policy must require individuals who appear to the responsible person to be under 18 years of age (or such older age as may be specified in the policy) to produce on request, before being served alcohol, identification bearing their photograph, date of birth and a holographic mark.
5. The responsible person shall ensure that;
  - (a) where any of the following alcoholic drinks is sold or supplied for consumption on the premises (other than alcoholic drinks sold or supplied having been made up in advance ready for sale or supply in a securely closed container) it is available to customers in the following measures—
    - (i) beer or cider: ½ pint;
    - (ii) gin, rum, vodka or whisky: 25 ml or 35 ml; and
    - (iii) still wine in a glass: 125 ml; and
  - (b) customers are made aware of the availability of these measures.

No supply of alcohol may be made under the premises licence-

- a) at a time where there is no designated premises supervisor in respect of the premises licence, or
- b) at a time when the designated premises supervisor does not hold a personal licence or his personal licence is suspended

Every supply of alcohol under the premises licence must be made or authorised by a person who holds a personal licence

### **Private Entertainment**

The premises may be used for the following purpose, that is to say, dancing, music, or other entertainment of the like kind which-

- a) is not a public entertainment but is promoted for private gain

### **Annex 2 - Conditions consistent with the operating Schedule**

#### **Regulated Entertainment**

Only recorded music, dance (performed by striptease artists), anything of a similar description

provision of facilities for making music, provision of facilities for dancing (performed by striptease artists), provision of facilities for entertainment of a similar description.

Provide a local taxi firm contact to drive customers home

#### **In relation to Striptease**

1. The total number of persons to be accommodated at the premises at any one time shall not exceed 100 persons.
2. The inward opening doors to Whitechapel Road, which provides emergency exit, shall be locked back in the open position when the premises are in use under this licence.
3. One leaf of the inward opening double doors which provide entry from Whitechapel Road shall be secured open at all times that the premises are occupied by the public.
4. All doors (apart from those specified in items 2 and 3) are to be kept closed during entertainment and satisfactory acoustic sealing should be applied to them.
5. There shall be no door provided to separate the "personal dance" area from the general bar area.
6. A registered door supervisor shall be positioned at the entry to the room providing the "personal dances" at all times that it is in use.
7. The number of performers that are performing within the "personal dance" area (excluding VIP area) at any one time shall not exceed three.
8. To the extent that striptease is permitted by law it shall be deemed in these conditions to apply to all forms of striptease or nudity by male or female performers.
9. Striptease shall only be permitted at premises which have a liquor licence.
10. The striptease entertainment shall be given only by paid performers/entertainers who are engaged exclusively for that purpose.

11. There shall be no physical participation by the audience.
12. Any performance will be restricted to dancing and the removal of clothes, here must not be any other form of sexual activity.
13. All striptease shall take place in an area which is not visible from the street or overlooking buildings.
14. The performance area shall be separated from the audience and consist of a stage, platform or similar construction or an area clearly identified as a performing area that meets with the approval of the Council.
15. The performer shall have direct access to a changing room without passing through the audience, or when direct access is not practical the performer shall be escorted from the stage by a steward or other employee of the licence holder.
16. The performer shall be provided with a changing room which must be separate and apart from public facilities.
17. There shall be no sexually explicit external advertising likely to cause offence as to the nature of the activity being held at the premises.
18. A notice shall be prominently displayed in a conspicuous position on the premises at least one hour before the start, advising customers when the performance is to commence.
19. Whilst striptease is taking place no person under the age of 18 shall be allowed on any part of the premises licensed for the sales of alcohol and a notice shall be displayed in clear terms at each entrance that :- **NO PERSON UNDER 18 TO BE ADMITTED**
20. The licensee shall ensure that gratuities are not thrown at the performer.
21. Where premises are within a radius of 100 metres of places of worship the entertainment shall not be held at such times as would cause offence to religious observers.
22. Where premises are within a radius of 100 metres of any school or educational establishment, striptease performances will not take place until after 8.30p.m. except on Saturday and Sunday.
23. There shall be no contact between the performer and any of the audience during performances
24. There shall be only one performer on the stage at any one time.

25. The layout of the premises must remain unaltered to that inspected and approved by the Council at the time of renewal or application; any alterations to the premises during the currency of the licence must be approved by the Council prior to the works commencing.
26. The number of performers that are performing within the VIP areas at any one time shall not exceed six.

**Annex 3 - Conditions attached after a hearing by the licensing authority**

Not Applicable

**Annex 4 - Plans**

The plans are those submitted to the licensing authority on the following date:

19 October 2010 - Ground Floor only.



*Licensing Act 2003*

**Part B - Premises licence summary**

**Premises licence number**

**14598**

**Premises details**

**Postal address of premises, or if none, ordnance survey map reference or description**

(The Nags Head Public House)  
17-19 Whitechapel Road  
E1 1DU

**Post town**

London

**Post code**

E1 1DU

**Telephone number**

Where the licence is time limited  
the dates

N/a

Licensable activities authorised  
by the licence

The sale by retail of alcohol  
The provision of regulated entertainment  
consisting of recorded music, performance of  
dance, anything of similar nature.  
Facilities for making music and dancing and  
similar nature.

The times the licence authorises the carrying out of licensable activities

Monday to Saturday 11 00 hrs to 03 00 hrs the following day  
Sunday 12 00 hrs to 22 30 hrs

The opening hours of the premises

From Monday to Saturday from 11 00 hrs until 03 30 hrs the following day  
Sunday 12 00 hrs to 23 00 hrs

Name, (registered) address of holder of premises licence

Karpal Singh and Shamsheer Singh  

Where the licence authorises supplies of alcohol whether these are on and / or off supplies

On and off sales

Registered number of holder, for example company number, charity number (where applicable)

N/A

Name of designated premises supervisor where the premises licence authorises for the supply of alcohol

Karpal Singh

State whether access to the premises by children is restricted or prohibited

Yes

# Appendix 3

## Application for the Grant, Renewal, Transfer or Variation of a Sexual Entertainment Venue Licence

Schedule 3 of the Local Government (Miscellaneous Provisions) Act 1982

**Part one of this form is open to inspection by the press and public**

**Please read the following instructions first**

Before completing this form please read the associated guidance notes. If you are completing this form by hand please write legibly in block capitals. In all cases ensure that your answers are inside the boxes and written in black ink. Use additional sheets if necessary. Please complete all sections or the application will be deemed incomplete and returned to the applicant.

**Applicants are warned that any person who, in connection with the grant, renewal, transfer or variation of a sexual entertainment licence, makes a false statement which they know to be false in any material respect, or which they do not believe to be true, is guilty of an offence and liable on summary conviction to a fine not exceeding £20,000.**

**Applicants are required to complete part one and part two of the application form, and provide any other documents listed in the form.**

You may wish to keep a copy of the completed form for your records.

### Part One: Details of Application

#### Section A: Type of Application

Please specify what type of application you are making:

**New**
                 
  **Renewal**
                 
  **Variation**
                 
  **Transfer**

**Licence Number (if applicable):** \_\_\_\_\_

#### Section B: Premises to be licensed

Is the application in respect of (tick as appropriate):

**Premises**
                 
  **Vehicle**
                 
  **Vessel**
                 
  **Stall**

Trading name and full postal address of premises to be licensed  
(If this application is in respect of a Vehicle, Vessel or Stall, then the location where it will be used)

Name: THE NAGS HEAD  
Address: 17-19 WHITECHAPEL ROAD

Post Town	<u>LONDON</u>	Postcode	<u>E1 1DU</u>
-----------	---------------	----------	---------------

Premises E-mail address	Premises contact telephone number(s)



### Section C: Applicant Details

Please state whether you are applying for a premises licence as

- |                                 |                                     |                         |
|---------------------------------|-------------------------------------|-------------------------|
| a) an individual or individuals | <input checked="" type="checkbox"/> | please complete box (1) |
| b) a limited company            | <input type="checkbox"/>            | please complete box (2) |
| c) a partnership                | <input type="checkbox"/>            | please complete box (2) |
| d) other                        | <input type="checkbox"/>            | please complete box (2) |

#### (1): First Individual Applicant Details

MR <input checked="" type="checkbox"/>	MRS <input type="checkbox"/>	MISS <input type="checkbox"/>	MS <input type="checkbox"/>	Other
First names <b>KARPAL</b>		Surname <b>SINGH</b>		
Address	<i>Please do not complete if this is a private residential address – This information is provided in Part 2</i>			
Age of applicant	Over 18:	Yes <input checked="" type="checkbox"/>	No <input type="checkbox"/>	

#### (1): Second Individual Applicant Details (Insert further pages if necessary for more than 2 applicants)

MR <input checked="" type="checkbox"/>	MRS <input type="checkbox"/>	MISS <input type="checkbox"/>	MS <input type="checkbox"/>	Other
First names <b>SHAMSHER</b>		Surname <b>SINGH</b>		
Address	<i>Please do not complete if this is a private residential address – This information is provided in Part 2</i>			
Age of applicant	Over 18:	Yes <input checked="" type="checkbox"/>	No <input type="checkbox"/>	

#### (2): Other Applicant Details

Name			
Registered number			
Description of applicant			
Registered Address			
Post Town		Postcode	

## Section D: Premises Details

1. What is the nature of the applicant's interest in the premises (please tick as appropriate)

- a) Freehold
- b) Leasehold

2. If the applicant's interest in the premises is a leasehold one, please state whether it is a:

- a) head lease
- b) sub lease

3. the name and full address of the landlord (if applicable)

ENTERPRISE INNS PLC, 3 MONKSPATH HALL ROAD, SOUHULL  
WEST MIDLANDS B90 4SJ

4. the name and full address of the superior landlord (if applicable)

N/A

5. Is the whole of the premises to be used under the licence?

- a) Yes
- b) No

6. If "no" please state which part of the premises is to be used for the purpose of the licence:

GROUND FLOOR

a) the use to which the remainder of the premises is put

BASEMENT = CELLAR + STORAGE FIRST FLOOR = MANAGEMENT  
OFFICES + BACK OF HOUSE

b) the name(s) of those who are responsible for the management of the remainder of the premises

MANPAL SINGH

7. Is the premises to be used for the purposes of the licence, so constructed or adapted as to permit access to and from the premises for members of the public who are disabled?

- a) Yes
- b) No

If "No" please state the applicant's proposals for affording such access

7. Is the premises, vehicle, vessel or stall which is to be used for the purposes of the licence, in use as a sex establishment at the date of this application?

- a) Yes   
b) No

If the answer is "Yes", please state the name and full address of the person(s) or body who operated the premises, vehicle, vessel or stall as a sex establishment at the date of this application, and the date (where known) the premises, vehicle, vessel or stall was first used as such

KARPAL + SHAMSHER SINGH (PLEASE SEE PERSONAL DETAILS FORMS FOR ADDRESS DETAILS)

If the answer is "No" please state the purpose(s) it is currently being used for

### Section E: Current Licences

1. Is the Premises licensed under any other Act (e.g. the Licensing Act 2003)?

- a) Yes   
b) No

2. If yes, please provide details of the licence(s), including the name of the Licence Holder and any Designated Premises Supervisor

PREMISES LICENCE NO: 14598

PREMISES LICENCE HOLDER: KARPAL SINGH + SHAMSHER SINGH

DESIGNATED PREMISES SUPERVISOR: KARPAL SINGH

### Section G: Advertising Details

When considering types of advertising in this section, please refer to the Councils Standard Conditions on Touting for Business and Premises Appearance, which are attached to the Sex Establishment Policy

1. What advertisement(s) or display(s) are to be exhibited on the exterior of the premises?

PLEASE REFER TO THE FRONT ELEVATION DRAWING  
SUBMITTED WITH THIS APPLICATION

2. Please state the size(s) of any advertisement(s) or display(s) mentioned in the above question

2 x SWING BOARDS - 11m x 9m

LOBBY SIGN - 6.2m x 6.2m

'THE NAGS HEAD' IN WHITE + BLACK LETTERING - 5.5m x 7m

'THE NAGS HEAD' IN BLACK + GOLD LETTERING - 3m x 3m

3. Please state any proposals for solicitation of the business in public areas. E.g. fliers, business cards, billboard advertising, personal solicitation or advertising on motor vehicles

FLIERS AND BUSINESS CARDS - 8.4cm x 5.5cm

FLIERS ARE HANDED OUT EXTERNAL TO LBTH

AND IN COMPLIANCE WITH THE SEXUAL ENTERTAINMENT  
VENUE LICENCE CONDITIONS.

**Section F: Business Details**

*Each person named in this section will need to complete Part 2 of the application – Personal Details Form*

1. Under what name will the business be trading?

NAGS HEAD LIMITED

2. If the applicant is a company or other corporate body, please give the names of the applicants directors and company secretary:

Name

\_\_\_\_\_  
 \_\_\_\_\_  
 \_\_\_\_\_  
 \_\_\_\_\_  
 \_\_\_\_\_  
 \_\_\_\_\_  
 \_\_\_\_\_

Use additional sheets to continue if necessary

2. Is the whole of the business owned by the applicant, and the applicant does not share the profits of the business with any other person or body?

- a) Yes
- b) No

If the answer is "No", please state the name(s) of those who will share in the profits of the business. In each case, please state the percentage share of the profits to be taken by each person or body involved in the ownership of the business

Name

Percentage share

Name	Percentage share
_____	_____
_____	_____
_____	_____
_____	_____
_____	_____
_____	_____
_____	_____
_____	_____
_____	_____
_____	_____

Use additional sheets to continue if necessary

**Section H: Operation of the Premises**

1. Please state the proposed opening times of the premises, vehicle, vessel or stall:  
(Gives times in a 24h clock format)

Day	Opening	Closing
Monday	11:00	03:00 THE DAY FOLLOWING
Tuesday	↑	↑
Wednesday	↑	↑
Thursday	↑	↑
Friday	↑	↑
Saturday	↓	↓
Sunday	12:00	22:30

2. What means are to be taken to prevent the interior of the premises, vehicle, vessel or stall for which the licence is sought from being visible to passers-by?

WINDOWS ON THE GROUND FLOOR ARE BOARDED OVER.  
ACCESS TO THE PREMISES IS VIA AN INTERNAL ENTRANCE LOBBY WITH SEPARATE DOOR LEADING TO THE AREA WHERE RELEVANT ENTERTAINMENT IS PROVIDED. THIS DOOR IS ONLY OPENED FOR ACCESS/EGRESS + DOORMEN LOCATED IN THE ENTRANCE LOBBY.

3. Have you read and understood the Councils standard conditions for sexual entertainment venues?

- a) Yes
- b) No

4. Are you able to comply with the Councils standard conditions for sexual entertainment venues?

- a) Yes
- b) No

If no, please give the reasons why not:

THIS IS AN APPLICATION FOR RENEWAL OF THE SEV LICENCE AT THE NAGS HEAD.

5. Please give details of any additional conditions you would like to propose, or conditions you like to amend or remove. The Council will expect applicants to address the following factors:

- a) Preventing nuisance to residents and businesses in the vicinity
- b) Public safety
- c) Preventing crime and disorder
- d) Protecting children from harm
- e) Procedures for checking employees age and right to work in the UK
- f) Procedures for training of all staff in the Code of Conduct for Dancers, and for compliance with licence conditions and requirements
- g) Procedures for notifying customers of the Dancers code of conduct
- h) System for monitoring compliance with the venues policy for welfare of dancers

PLEASE REFER TO ENCLOSED DOCUMENTS INCLUDING  
EXTANT SEXUAL ENTERTAINMENT, LICENCE CONDITIONS  
VENUE

WHICH ARE PROPOSED CONTINUE FOLLOWING THIS  
APPLICATION.

**Section I: Management of the Premises**

*Each person named in this section will need to complete Part 2 of the application – Personal details form*

1. Please give the name of the person who will be responsible for the day to day management of the premises. ("the Manager")

Name: MR MANPAL + MR SHAMSHER SINGH

Role: MANAGERS

2. Will this person be based at the premises and will the management of the premises be their sole and exclusive occupation?

- a) Yes
- b) No

3. If no, then please give details of how they are responsible for the day to day management, and what other arrangements are in place for the management of the premises.

MANPAL SINGH AND SHAMSHER SINGH ARE RESPONSIBLE FOR THE DAY TO DAY MANAGEMENT OF THE PREMISES. RELIEF MANAGERS TO BE PRESENT WHEN EITHER UNAVAILABLE.

4. Which person(s) will be responsible for the day to day management in the absence of the Manager (Use continuation sheets if necessary):

Name: BAHADUR SINGH BINNING      Name:  
Role: RELIEF MANAGER                      Role:

Name: ALCIR ORLANDI                      Name:  
Role: RELIEF MANAGER                      Role:

Name:    Name:  
Role:    Role:

Name:    Name:  
Role:    Role:

5. Please confirm that at least one of the people named in this section will be at the premises at all times whilst it is open.

- a) Yes
- b) No



Section J: Details of any further information relevant to this application

Please state below any further information which the applicant would wish to be taken into account when this application is considered (This space may also be used to amplify answers to any previous questions)

THIS IS AN APPLICATION FOR RENEWAL OF A SEXUAL ENTERTAINMENT VENUE LICENCE. THE PREMISES HAS OPERATED UNDER AN SEV LICENCE FOR ONE YEAR AND AS A SEV FOR APPROX. YEARS.

FULL DOCUMENTATION HAS BEEN SUPPLIED IN FURTHERANCE OF THIS APPLICATION AND THE APPLICANT IS HAPPY TO SUPPLY ANY FURTHER INFORMATION REASONABLY REQUESTED BY THE RESPONSIBLE AUTHORITY.

**Section L: Correspondence and Contact Details for the Application**

Please give details of the person who may be contacted in relation to this application

Name: LUKE ELFORD / JULIAN SKEENS  
 Organisation: TLT LLP  
 Postal Address: 20 GRESHAM STREET, LONDON EC2V 7JE  
 Telephone Number: [REDACTED]  
 Email: [REDACTED]  
 Position/role:  
 (e.g. Solicitor/Agent for the applicant) SOLICITORS FOR THE APPLICANT.

**Section M: Private Information**

Is there any information on this form which you do not wish to be seen by members of the public? If so, state which information and the reasons why you do not wish it to be seen. Please note, any requests of this nature will be dealt on a case by case basis, and you will be contacted to discuss further if the information is considered necessary for public disclosure.

PERSONAL ADDRESSES/CONTACT DETAILS  
 CRIMINAL RECORD INFORMATION

**Section N: Declaration and signature of applicant**

The declaration must be signed in all cases :

- a) If the applicant is an individual, by that individual
- b) If the applicant is a partnership, by all individuals who are partners
- c) If the applicant is a company, by a director or the company secretary
- d) In any other case by a duly authorised officer of the applicant

I acknowledge that I have received a copy of the standard conditions applicable to a sex establishment licence within the London Borough of Tower Hamlets, and declare that the information given within this application form, to the best of my knowledge, is true and complete in every respect.

*Please use extra pages if necessary*

Name: LUKE ELFORD	Signature	[REDACTED]
Position: SOLICITOR FOR THE APPLICANT	Date	17 / 05 / 2016
Name: FOR TLT LLP	Signature	
Position:	Date	

### Section K: Additional documentary requirements

The applicant must provide the following documentation, in addition to those documents already requested in prior sections of this application form.

Documents included with this application		Included
1	The prescribed fee, in the form of a cheque made payable to the London Borough of Tower Hamlets (LBTH).	Yes <input checked="" type="checkbox"/> No <input type="checkbox"/>
2	Written consent of the lawful occupier of the premises or land who has control over the premises or land	Yes <input checked="" type="checkbox"/> No <input type="checkbox"/>
3	Code of practice for dancers/performers	Yes <input checked="" type="checkbox"/> No <input type="checkbox"/>
4	Policy for welfare of dancers/performers	Yes <input checked="" type="checkbox"/> No <input type="checkbox"/>
5	Code of practice for customers	Yes <input checked="" type="checkbox"/> No <input type="checkbox"/>
6	A personal details form (Part 2 of the application form) for each person named in the application	Yes <input checked="" type="checkbox"/> No <input type="checkbox"/>
7	A basic CRB check for each person named in the application	Yes <input type="checkbox"/> No <input checked="" type="checkbox"/> *
8	A recent passport size photograph for each person named in the application, each copy bearing the name in block capitals of the person whose likeness it bears.	Yes <input checked="" type="checkbox"/> No <input type="checkbox"/>
9	A site/location plan, (scale 1:1250) to show the location of the premises	Yes <input checked="" type="checkbox"/> No <input type="checkbox"/>
10	<p>A premises plan (scale 1:100) of the premises, vehicle, vessel or stall in respect of which the licence is sought, showing:</p> <ul style="list-style-type: none"> <li>a) The internal layout of the premises including stage, bars, cloakroom, WCs, performance areas, dressing rooms, kitchen, and any external areas to be used (e.g. smoking areas).</li> <li>b) Public areas and staff/private areas to be clearly defined</li> <li>c) Uses for different areas in the premises (e.g. performance areas, reception etc.)</li> <li>d) Any fixed structures or objects</li> <li>e) all means of ingress and egress from the premises</li> <li>f) Position of CCTV cameras</li> <li>g) The location and type of any fire safety and any other safety equipment</li> <li>h) The location of emergency exits</li> <li>i) The position of ramps, lifts or other facilities for the benefit of disabled people.</li> <li>j) Any parts of the premises that may be inaccessible to disabled people.</li> </ul> <p><i>Other standard metric scales may be acceptable if more practical for the size of the premises.</i></p>	Yes <input checked="" type="checkbox"/> No <input type="checkbox"/>
11	A drawing (scale 1:100) showing the front elevation as existing (and as proposed if changes are to be made to it) of the premises, vehicle, vessel or stall in respect of which the licence is sought. Other standard metric scales may be acceptable if more practical for the size of the premises.	Yes <input checked="" type="checkbox"/> No <input type="checkbox"/>
<b>Evidence of public notice and service</b>		
12	Complete copy of the newspaper advert advertising the application <i>TO FOLLOW</i>	Yes <input type="checkbox"/> No <input checked="" type="checkbox"/>
13	Copy of the notice displayed on or near the premises advertising the application	Yes <input checked="" type="checkbox"/> No <input type="checkbox"/>
14	Copy of affidavit or statutory declaration that the notice of application has been displayed on or near the premises, in a place where the notice can be conveniently read by the public as required by paragraph 10(10) schedule 3 to the Local Government (Miscellaneous Provisions) Act 1982 (as amended). <i>TO FOLLOW</i>	Yes <input type="checkbox"/> No <input checked="" type="checkbox"/>
15	Evidence of the due service upon the Chief officer of police as required by paragraph 10(14) schedule 3 to the Local Government (Miscellaneous Provisions) Act 1982 (as amended), of a copy of this application and its required documentation. <i>TO FOLLOW</i>	Yes <input type="checkbox"/> No <input checked="" type="checkbox"/>

\* TO FOLLOW

I, **RACHEL KELLY** confirm that I sent a complete copy of the application for renewal of a sexual entertainment venue licence for The Nags Head, 17 – 19 Whitechapel Road, London E1 1DU to the Chief Officer of Police by first class post on **17 May 2016** in accordance with the provisions of Schedule 3 section 14 of the Local Government (Miscellaneous Provisions) Act 1982

Signed:  .....

Name: **RACHEL KELLY**

Dated: *17/05/16* .....

## Application for the Grant, Renewal, Transfer or Variation of a Sexual Entertainment Venue Licence

Schedule 3 of the Local Government (Miscellaneous Provisions) Act 1982

### Part Two: Personal Details Form

A separate form must be completed by every person named in the application, including any individual who will be responsible for management of the premises in the absence of the licence holder. Where the applicant is not an individual, then a form should be completed for each director or partner etc.

This part of the application will not be made publicly available, but will be made available to officers of the Council, a sub-committee or committee determining the application and to other relevant public bodies such as the Police.

Forename(s)	KARPAL	Date of Birth	[REDACTED]	
Surname	SINGH	Place of Birth	[REDACTED]	
Previous Name(s)		Date of becoming a UK resident	[REDACTED]	
Gender	MALE			
Permanent Residential Address:		[REDACTED]		
Any previous address within the last 3 years		NO		
Position in relation to the applicant (e.g. Director, Partner, Manager etc)				
1. Have you ever been convicted of a criminal offence, whether in the UK or elsewhere? Yes <input checked="" type="checkbox"/> No <input type="checkbox"/>				
If yes, please complete the details below:				
Name at time of conviction	Date of conviction	Place of conviction	Nature of offence	Sentence
[REDACTED]				
Please continue on a separate sheet if necessary.				
2. To your knowledge, are you currently the subject of any criminal investigation?				Yes <input type="checkbox"/> No <input checked="" type="checkbox"/>
If yes, please provide full details:				
3. Have you ever had any civil legal action taken against you?				Yes <input type="checkbox"/> No <input checked="" type="checkbox"/>
If yes, please provide full details:				

4. Have you ever been disqualified from holding a sex establishment licence? Yes  No

If Yes, please provide details:

5. Have you ever been involved in the management of a business, whether as a proprietor, director, company secretary, partner, manager, supervisor or otherwise which has had any of the following types of licence refused, reviewed or revoked?

Sex Establishment licence	Yes <input type="checkbox"/> No <input checked="" type="checkbox"/>
Licence for the sale or supply of alcohol	Yes <input type="checkbox"/> No <input checked="" type="checkbox"/>
Licence for the provision of entertainment, whether sexual or otherwise.	Yes <input type="checkbox"/> No <input checked="" type="checkbox"/>
Personal licence under the Licensing Act 2003	Yes <input type="checkbox"/> No <input checked="" type="checkbox"/>

If yes to any of the above, please provide full details:

6. Have you ever been declared bankrupt or entered into an arrangement with creditors or an Individual Voluntary Arrangement? Yes  No

If yes, please provide full details:

7. Have you ever been disqualified from acting as a company director? Yes  No

If yes, please provide full details:

8. Please state any further information that you wish to be taken into account when the application is considered.

I declare that the information on this form is true and complete.

Name: KARPAL SINGH

Date 22/04/2016

Position DPS - MANAGER



**Application for the Grant, Renewal, Transfer or Variation of a Sexual  
Entertainment Venue Licence**  
Schedule 3 of the Local Government (Miscellaneous Provisions) Act 1982

**Part Two: Personal Details Form**

A separate form must be completed by every person named in the application, including any individual who will be responsible for management of the premises in the absence of the licence holder. Where the applicant is not an individual, then a form should be completed for each director or partner etc.

This part of the application will not be made publicly available, but will be made available to officers of the Council, a sub-committee or committee determining the application and to other relevant public bodies such as the Police.

Forename(s)	SHAMSHER	Date of Birth		
Surname	SINGH	Place of Birth		
Previous Name(s)		Date of becoming a UK resident		
Gender	MALE			
Permanent Residential Address:				
Any previous address within the last 3 years		NO		
Position in relation to the applicant (e.g. Director, Partner, Manager etc)		MANAGER		
1. Have you ever been convicted of a criminal offence, whether in the UK or elsewhere? Yes <input type="checkbox"/> No <input checked="" type="checkbox"/>				
If yes, please complete the details below:				
Name at time of conviction	Date of conviction	Place of conviction	Nature of offence	Sentence
Please continue on a separate sheet if necessary.				
2. To your knowledge, are you currently the subject of any criminal investigation?				Yes <input type="checkbox"/> No <input checked="" type="checkbox"/>
If yes, please provide full details:				
3. Have you ever had any civil legal action taken against you?				Yes <input type="checkbox"/> No <input checked="" type="checkbox"/>
If yes, please provide full details:				

4. Have you ever been disqualified from holding a sex establishment licence? Yes  No

If Yes, please provide details:

5. Have you ever been involved in the management of a business, whether as a proprietor, director, company secretary, partner, manager, supervisor or otherwise which has had any of the following types of licence refused, reviewed or revoked?

Sex Establishment licence	Yes <input type="checkbox"/> No <input checked="" type="checkbox"/>
Licence for the sale or supply of alcohol	Yes <input type="checkbox"/> No <input checked="" type="checkbox"/>
Licence for the provision of entertainment, whether sexual or otherwise.	Yes <input type="checkbox"/> No <input checked="" type="checkbox"/>
Personal licence under the Licensing Act 2003	Yes <input type="checkbox"/> No <input checked="" type="checkbox"/>

If yes to any of the above, please provide full details:

6. Have you ever been declared bankrupt or entered into an arrangement with creditors or an Individual Voluntary Arrangement? Yes  No

If yes, please provide full details:

7. Have you ever been disqualified from acting as a company director? Yes  No

If yes, please provide full details:

8. Please state any further information that you wish to be taken into account when the application is considered.

I declare that the information on this form is true and complete.

Name: SHAMSHER SINGH

Date: 22/04/2016

Position: MANAGER



**Application for the Grant, Renewal, Transfer or Variation of a Sexual  
Entertainment Venue Licence**  
Schedule 3 of the Local Government (Miscellaneous Provisions) Act 1982

**Part Two: Personal Details Form**

A separate form must be completed by every person named in the application, including any individual who will be responsible for management of the premises in the absence of the licence holder. Where the applicant is not an individual, then a form should be completed for each director or partner etc.

This part of the application will not be made publicly available, but will be made available to officers of the Council, a sub-committee or committee determining the application and to other relevant public bodies such as the Police.

Forename(s)	MANPAL	Date of Birth	[REDACTED]	
Surname	SINGH	Place of Birth	[REDACTED]	
Previous Name(s)		Date of becoming a UK resident	[REDACTED]	
Gender	MALE			
Permanent Residential Address:		[REDACTED]		
Any previous address within the last 3 years		NO		
Position in relation to the applicant (e.g. Director, Partner, Manager etc)		MANAGER		
1. Have you ever been convicted of a criminal offence, whether in the UK or elsewhere? Yes <input type="checkbox"/> No <input checked="" type="checkbox"/>				
If yes, please complete the details below:				
Name at time of conviction	Date of conviction	Place of conviction	Nature of offence	Sentence
Please continue on a separate sheet if necessary.				
2. To your knowledge, are you currently the subject of any criminal investigation?				Yes <input type="checkbox"/> No <input checked="" type="checkbox"/>
If yes, please provide full details:				
3. Have you ever had any civil legal action taken against you?				Yes <input type="checkbox"/> No <input checked="" type="checkbox"/>
If yes, please provide full details:				

4. Have you ever been disqualified from holding a sex establishment licence? Yes  No

If Yes, please provide details:

5. Have you ever been involved in the management of a business, whether as a proprietor, director, company secretary, partner, manager, supervisor or otherwise which has had any of the following types of licence refused, reviewed or revoked?

Sex Establishment licence	Yes <input type="checkbox"/> No <input checked="" type="checkbox"/>
Licence for the sale or supply of alcohol	Yes <input type="checkbox"/> No <input checked="" type="checkbox"/>
Licence for the provision of entertainment, whether sexual or otherwise.	Yes <input type="checkbox"/> No <input checked="" type="checkbox"/>
Personal licence under the Licensing Act 2003	Yes <input type="checkbox"/> No <input checked="" type="checkbox"/>

If yes to any of the above, please provide full details:

6. Have you ever been declared bankrupt or entered into an arrangement with creditors or an Individual Voluntary Arrangement? Yes  No

If yes, please provide full details:

7. Have you ever been disqualified from acting as a company director? Yes  No

If yes, please provide full details:

8. Please state any further information that you wish to be taken into account when the application is considered.

I declare that the information on this form is true and complete.

Name: MANPAL SINGH

Date 22/04/2016

Position MANAGER



**Application for the Grant, Renewal, Transfer or Variation of a Sexual  
Entertainment Venue Licence**  
Schedule 3 of the Local Government (Miscellaneous Provisions) Act 1982

**Part Two: Personal Details Form**

A separate form must be completed by every person named in the application, including any individual who will be responsible for management of the premises in the absence of the licence holder. Where the applicant is not an individual, then a form should be completed for each director or partner etc.

This part of the application will not be made publicly available, but will be made available to officers of the Council, a sub-committee or committee determining the application and to other relevant public bodies such as the Police.

Forename(s)	ALCIR	Date of Birth		
Surname	ORLANDI	Place of Birth		
Previous Name(s)		Date of becoming a UK resident		
Gender	MALE			
Permanent Residential Address:				
Any previous address within the last 3 years		NO		
Position in relation to the applicant (e.g. Director, Partner, Manager etc)		RELIEF MANAGER		
1. Have you ever been convicted of a criminal offence, whether in the UK or elsewhere? Yes <input type="checkbox"/> No <input checked="" type="checkbox"/>				
If yes, please complete the details below:				
Name at time of conviction	Date of conviction	Place of conviction	Nature of offence	Sentence
Please continue on a separate sheet if necessary.				
2. To your knowledge, are you currently the subject of any criminal investigation?				Yes <input type="checkbox"/> No <input checked="" type="checkbox"/>
If yes, please provide full details:				
3. Have you ever had any civil legal action taken against you?				Yes <input type="checkbox"/> No <input checked="" type="checkbox"/>
If yes, please provide full details:				

4. Have you ever been disqualified from holding a sex establishment licence? Yes  No

If Yes, please provide details:

5. Have you ever been involved in the management of a business, whether as a proprietor, director, company secretary, partner, manager, supervisor or otherwise which has had any of the following types of licence refused, reviewed or revoked?

Sex Establishment licence	Yes <input type="checkbox"/> No <input checked="" type="checkbox"/>
Licence for the sale or supply of alcohol	Yes <input type="checkbox"/> No <input checked="" type="checkbox"/>
Licence for the provision of entertainment, whether sexual or otherwise.	Yes <input type="checkbox"/> No <input checked="" type="checkbox"/>
Personal licence under the Licensing Act 2003	Yes <input type="checkbox"/> No <input checked="" type="checkbox"/>

If yes to any of the above, please provide full details:

6. Have you ever been declared bankrupt or entered into an arrangement with creditors or an Individual Voluntary Arrangement? Yes  No

If yes, please provide full details:

7. Have you ever been disqualified from acting as a company director? Yes  No

If yes, please provide full details:

8. Please state any further information that you wish to be taken into account when the application is considered.

I declare that the information on this form is true and complete.

Name: ALCIR, ORLANDI Date 22/04/2016

Position RELIEF MANAGER

**Application for the Grant, Renewal, Transfer or Variation of a Sexual  
 Entertainment Venue Licence**  
 Schedule 3 of the Local Government (Miscellaneous Provisions) Act 1982

**Part Two: Personal Details Form**

A separate form must be completed by every person named in the application, including any individual who will be responsible for management of the premises in the absence of the licence holder. Where the applicant is not an individual, then a form should be completed for each director or partner etc.

This part of the application will not be made publicly available, but will be made available to officers of the Council, a sub-committee or committee determining the application and to other relevant public bodies such as the Police.

Forename(s)	BAHADUR SINGH	Date of Birth		
Surname	BINNING	Place of Birth		
Previous Name(s)	BAHADUR SINGH	Date of becoming a UK resident		
Gender	MALE			
Permanent Residential Address:				
Any previous address within the last 3 years		NO		
Position in relation to the applicant (e.g. Director, Partner, Manager etc)		RELIEF MANAGER		
1. Have you ever been convicted of a criminal offence, whether in the UK or elsewhere? Yes <input type="checkbox"/> No <input checked="" type="checkbox"/>				
If yes, please complete the details below:				
Name at time of conviction	Date of conviction	Place of conviction	Nature of offence	Sentence
Please continue on a separate sheet if necessary.				
2. To your knowledge, are you currently the subject of any criminal investigation?				Yes <input type="checkbox"/> No <input checked="" type="checkbox"/>
If yes, please provide full details:				
3. Have you ever had any civil legal action taken against you?				Yes <input type="checkbox"/> No <input checked="" type="checkbox"/>
If yes, please provide full details:				

4. Have you ever been disqualified from holding a sex establishment licence? Yes  No

If Yes, please provide details:

5. Have you ever been involved in the management of a business, whether as a proprietor, director, company secretary, partner, manager, supervisor or otherwise which has had any of the following types of licence refused, reviewed or revoked?

Sex Establishment licence	Yes <input type="checkbox"/> No <input checked="" type="checkbox"/>
Licence for the sale or supply of alcohol	Yes <input type="checkbox"/> No <input checked="" type="checkbox"/>
Licence for the provision of entertainment, whether sexual or otherwise.	Yes <input type="checkbox"/> No <input checked="" type="checkbox"/>
Personal licence under the Licensing Act 2003	Yes <input type="checkbox"/> No <input checked="" type="checkbox"/>

If yes to any of the above, please provide full details:

6. Have you ever been declared bankrupt or entered into an arrangement with creditors or an Individual Voluntary Arrangement? Yes  No

If yes, please provide full details:

7. Have you ever been disqualified from acting as a company director? Yes  No

If yes, please provide full details:

8. Please state any further information that you wish to be taken into account when the application is considered.

I declare that the information on this form is true and complete.

Name: BAHADUR SINGH BINNING

Date

22/04/2016

Position: RELIEF MANAGER



# Appendix 4



# Nags Head



Scale 1:769

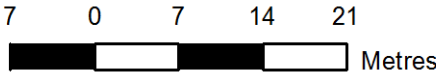



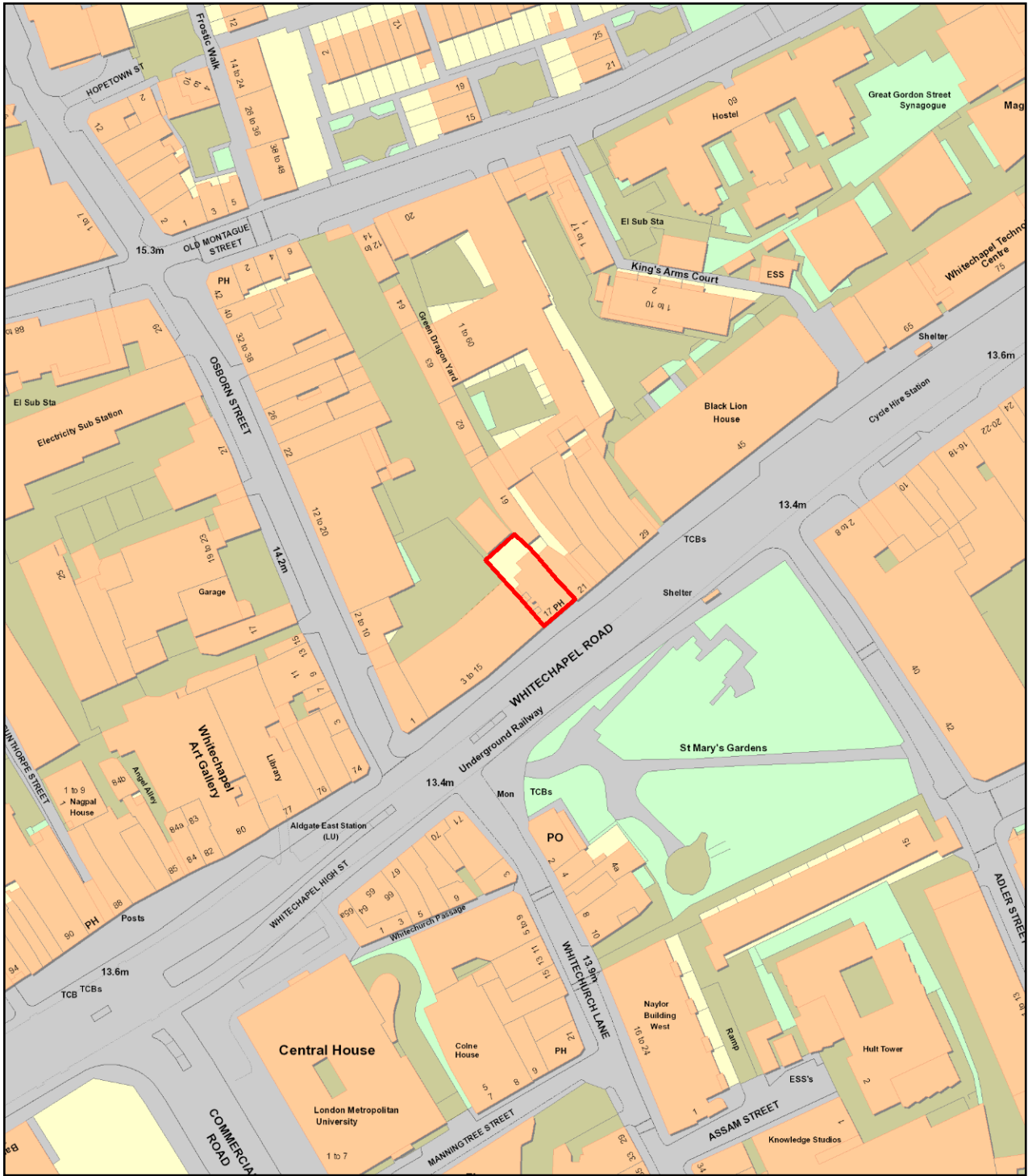

# Nags Head



Scale 1:1537

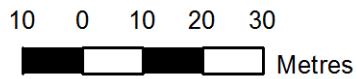



# Nags Head



Scale 1:3074

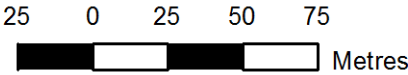

# Appendix 5



Produced 19 Nov 2014 from the Ordnance Survey National Geographic Database and incorporating surveyed revision available at this date. Reproduction in whole or part is prohibited without the prior permission of Ordnance Survey. © Crown Copyright 2014

Ordnance Survey and the OS Symbol are registered trademarks of Ordnance Survey, the national mapping agency of Great Britain.

The representation of a road, track or path is no evidence of a right of way. The representation of features as lines is no evidence of a property boundary.

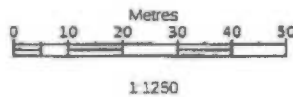

17-19, Whitechapel Rd, London  
 E1 1DU

Supplied by **Stanfords** 19 Nov 2014  
 Stanfords Ordnance Survey Partner  
 Licence 100035409  
 Order Licence Reference O1784696  
 Centre coordinates 534063 181510

Do not scale dimensions of this drawing.  
 Check all dimensions and record any discrepancies  
 before construction commences. It is the contractor's  
 liability for construction measurements of any  
 elements not shown on drawings and other  
 approved documents.

⊕ CCTV

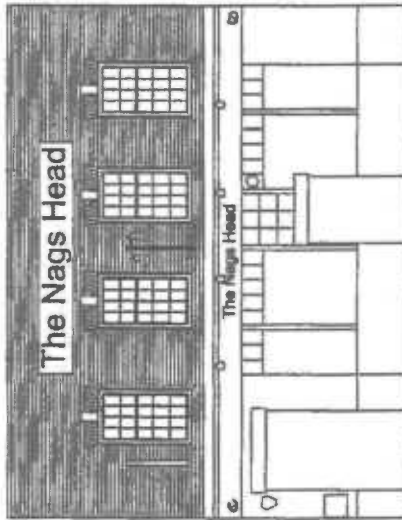

1001/11 June 2014 Preliminary design  
 Tulsa Manton / Architects

1001/11 June 2014 Preliminary design  
 1001/11 June 2014 Preliminary design

THE NAGS HEAD  
 1001/11 WHITECHAPEL ROAD,  
 LONDON, E1 1BB

EXISTING FRONT ELEVATION

DATE	BY	APP'D
1001/11	1001/11	1001/11
1001/11	1001/11	1001/11

THE NAGS HEAD GENTLEMAN'S VENUE

- KEY: AREAS TO WHICH THE PUBLIC HAVE ACCESS/  
 — = IN WHICH A TRANSACTION COULD TAKE PLACE (EXC. WC'S)  
 — = AREAS IN WHICH REGULATED ENTERTAINMENT WILL TAKE PLACE  
 ● = CCTV CAMERAS  
 ✕ = ENTERTAINMENT TARIFF + HOUSE RULES  
 ✖ = DRINK TARIFF  
 □ = CODE OF CONDUCT FOR DANCERS

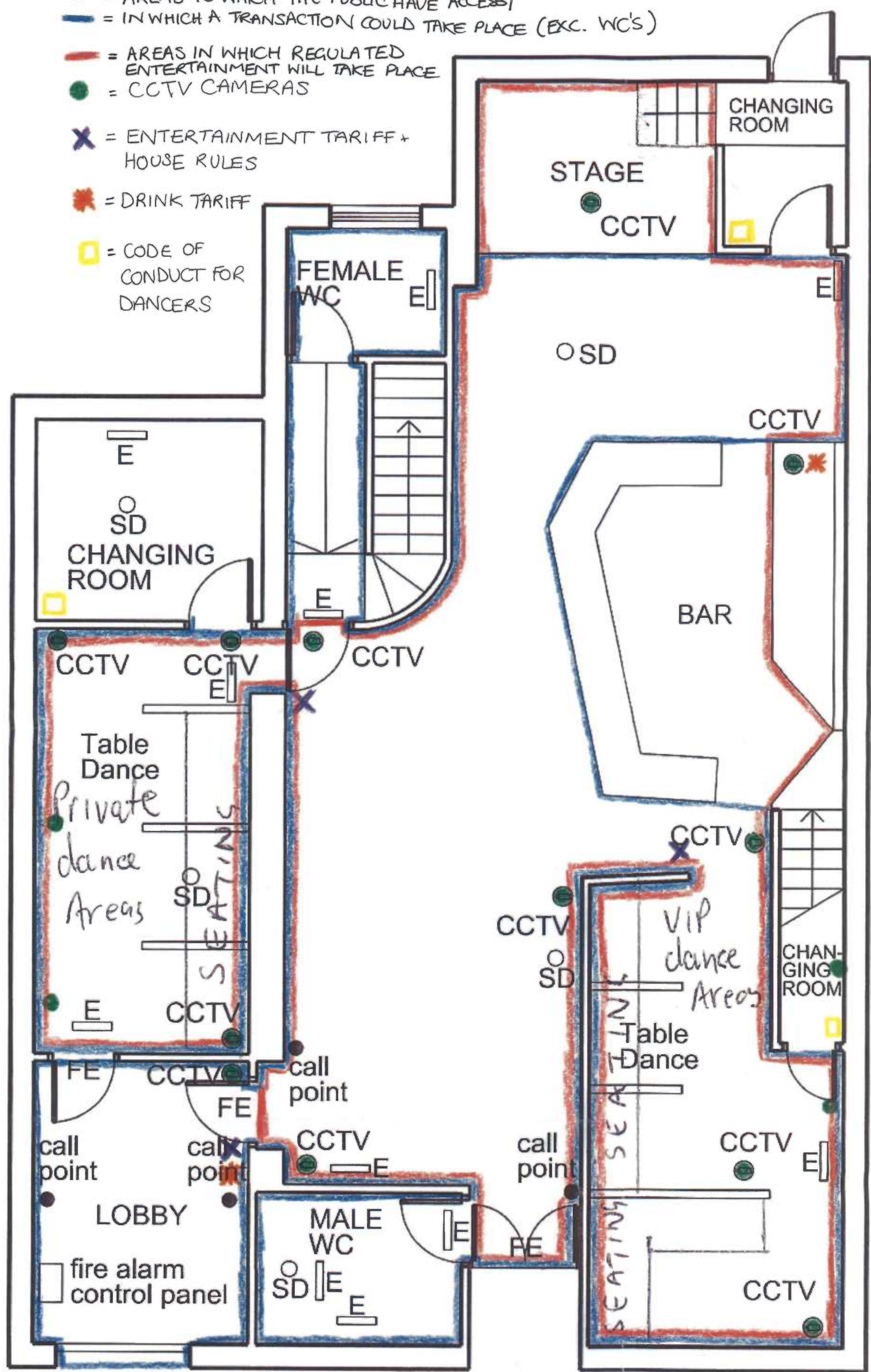

ENTRANCE

# Appendix 6

**Date: 22<sup>nd</sup> June 2016**

**Premises Name: The Nags Head**

**Address: 17 – 19 Whitechapel Road, London E1 1DU**

**Persons Present: LBTH Licensing Officer: Mohshin Ali**

**Attendees: Manpal Singh (Manager), Saab Binning (Manager) and Luke Elford(TLT Solicitors)**

<b>Condition Check</b>	<b>Notes</b>
<p><b>Code of Conduct for Performers</b></p> <p>Each performer must sign the Code of Conduct in their proper name, acknowledging that they have read and understood and are prepared to abide by the Code of Conduct.</p> <p><i>Is there a Code of Conduct in place?</i></p>	<p>Yes, as provided with the application and signed versions shown.</p>
<p><b>House Rules</b></p> <p>The House Rules shall be prominently and legibly displayed close to each entrance of the Premises.</p> <p>The House Rules must be made known to customers prior to their admission to the Premises when sexual entertainment is provided</p> <p>Signs must be displayed at appropriate locations advising that any customer attempting to make physical contact with a performer will be asked to leave.</p>	<p>In place at the entrance to the premises and is made known to customers.</p> <p>Customers are advised at the door</p> <p>Signs are available at the entrance on tables within the club and the rooms/booths.</p>
<p><b>Performer Safety Policy</b></p> <p>There must be a suitable policy for the safety of the performers when they leave the Premises.</p>	<p>This is contained within the Performance Welfare Policy and is displayed in the dressing room.</p>



<p><i>This may take the form of a notice in the dressing room</i></p>	
<p><b>Door Staff</b></p> <p>A suitable and sufficient number of door supervisors and trained staff will be employed (based on a risk assessment) when sexual entertainment is offered.</p> <p><i>Details of Door Staff would ideally be retained in a log.</i></p>	<p>Logs are ok. They have signing in sheets which show who has worked each shift.</p>
<p><b>The Venue interior</b></p> <p>The interior of the Premises where sexual entertainment is offered shall not be capable of being seen from the outside of the Premises.</p>	<p>Cannot be seen from outside as lobby doors are closed</p>
<p><b>The Venue Exterior</b></p> <p>The exterior is maintained with a suitable level of decorum (i.e. that it does not have anything that depicts, indicates or suggests that sexual entertainment takes place on the Premises).</p>	<p>All ok. No advertising outside the premises</p>
<p><b>Public Access</b></p> <p>No member of the public shall be permitted to go anywhere outside the public areas. The public shall not be permitted access to the performers' changing rooms.</p> <p><i>What would happen if a member of public was found in a non-public area?</i></p> <p>Members of the public may not enter or remain in the toilet cubicles in the company of any performer. Only one person at a time to enter a toilet cubicle.</p>	<p>If a member of the public was found in a non-public access area, they would be asked to leave the premises.</p> <p>Changing rooms have locks and staff only signs.</p> <p>If a customer was found with a patron in the toilet together, the performer would be sacked.</p>

<p><i>What would happen to the performer and patron if they were found in a toilet cubicle together?</i></p>	
<p><b>CCTV</b></p> <p>CCTV shall be installed to cover the inside and the outside of the Premises, covering all public areas, including private performance areas and booths, entrances and exits, but excluding the interior of toilets. All cameras must be maintained in working order. All cameras shall continually record whilst the Premises are open to the public and the recorded images shall be kept available for a minimum of 31 days.</p> <p><i>Check all the above. Ask to see recordings from previous days from multiple cameras.</i></p> <p><i>Specifically, is there CCTV covering:</i></p> <ul style="list-style-type: none"> <li>• <b>Public Access Areas</b></li> <li>• <b>Performance Areas and Booths</b></li> <li>• <b>Entrances and Exits</b></li> </ul>	<p>All in working order and relevant areas covered. Recordings of previous days shown.</p>
<p><b>Advertising</b></p> <p>The Licensee shall neither cause nor permit the display of suggestive advertising content which is directed at or may be seen or heard by any person from within the London Borough of Tower Hamlets, on any public highway, street, waterway or railway; in any place of general public use or access; or in publicly accessible areas of premises open to the public.</p> <p><i>How does the venue advertise?</i></p> <p><i>If there is a website, is it compliant?</i></p>	<p>Flyers are handed out but outside of Tower Hamlets</p> <p>There is also websites:</p> <p><a href="http://www.nagsheadgentlemensvenue.com/">www.nagsheadgentlemensvenue.com/</a></p> <p>There are some images of semi-nude women and in lingerie. There is no 'Over 18' entry tab.</p>

**Performers**

With each record the Licensee shall keep a copy of a photographic form of identity and proof of address of the performer. With each record the Licensee shall keep a clear copy of an authorised document demonstrating that each Performer and each member of the staff is entitled to work within the UK.

*These should be retained and made available for inspection. Is there a copy of this log?*

On days when sexual entertainment is provided, the Licensee or their representative shall keep a record of those performers working at the Premises on that day in a daily record.

*Is there a copy of this log?*

A log was kept and shown. Each performer signs to declare they have read and understand the club's policies. Examples were shown including passports and proof of a right to work.

Logs for the dancers were shown.

**Tariffs**

The Licensee shall prominently and legibly display the drinks tariff at or by the bar and at the entrance.

*Are these available?*

The Licensee shall so far as reasonably practicable keep such records as are necessary to prove that the sums charged and payments taken are for products or services advertised on the relevant tariff at the amount shown on that tariff.

*Is there a log?*

Yes. Drinks tariff at the entrance, the rooms.

Yes, log shown. Price against the tariff was shown.

Additional Notes:

- Licensing Act 2003 Summary was displayed
- SEV licence displayed and available

# Appendix 7

The Nags Head

The Nags Head

drop

BAKEM



# Appendix 8

THE NAG'S HEAD  
CUSTOMER HOUSE RULES

The premises operates a smart casual dress code to which you must conform (clearly stated in reception). You must be decently attired on arrival and departure from the premises

No person under the age of 18 will be admitted.

We operate a challenge 21 policy. If you are lucky enough to look under 21 you will be required to produce a valid I.D (either a passport or driving licence).

You must remain fully clothed while on the club premises.

You are required to contribute a minimum of £1 for each and every stage dance.

You may not take any photograph inside the premises. (Please keep your camera phone in your pocket).

Should behave in an appropriate manner outside the premises so as not to cause disturbance to any local residents in the neighbourhood.

Management reserves the right to refuse admission and to remove customers who fail to comply with the stated rules of the club including causing disturbance to any local residents in the neighbourhood.

**The following rules must be followed whilst any performer is dancing for you:**

Before a dancer may perform, you must be seated with your back against the back of the seat and your hands by your side. You must remain seated for the duration of the dance.

You must not touch the performer during her performance.

You must not attempt to arrange to meet any performer privately or to give your telephone number or business card for that purpose.

You should not ask the performer to perform any sexual favour or use any profane language.

You must not perform any act of masturbation or indulge in other sexual behaviour.

Failure to comply with this code may result in you being asked to leave the premises without refund of any monies paid.



# The Nags Head

## Performer Guidelines

- Performers may not commence performing at the premises until the induction process is complete and proof of identity and entitlement to work has been provided.
- Performers must always sign in with Management before starting each shift.
- Performers are to arrive within adequate time to ensure that they are ready to perform on the main floor or to carry out other duties as requested by the duty manager.
- Performers shall use the dressing room facilities provided to change into appropriate attire as required by the Premises.
- Performers appropriate attire shall include:
  - Floor length elegant gowns and high heel shoes as approved by the management. The Nags Head reserves the right to specify what is and is not appropriate on a continual basis.
  - Performer's hair and make-up must be presented professionally.
- Performers are never to intentionally meet any Customer outside of the Premises.
- Performers are never to agree to meet a Customer outside of the Premises.
- Performers must never engage in any unlawful activity within the Premises.
- Performers may only consume alcohol in moderation. Performers shall not perform if intoxicated.
- Performers must never consume, possess or be under the influence of any unlawful drug or substance, unless it is prescribed medication by a registered doctor.
- Performers are never to invite or knowingly permit Performer's spouse, boyfriend nor anyone else with whom Performers are romantically involved to enter the venue
- Performers are required from time to time to participate in promotional activities and offers as designated by Management
- Performers are required from time to time to participate in stage performances as designated by Management.
- Performers shall only use the smoking area in the rear court yard provided for their use.
- For the purposes of safety and compliance, The Nags Head employs the use of closed circuit cameras and radio communications throughout the Premises.
- Any dancer found to be in breach of any of these rules, without reasonable excuse, will be subject to the disciplinary procedure which may result in being

excluded from the Nag's Head.

- The Nags Head has zero tolerance for prostitution, solicitation, drug misuse, and illegal conduct.

By signing this document you signify that you, the Performer, have read and understood The Nags Head Performer Code of Conduct, The Nags Head Performer Welfare Policy, The Nags Head Performer Guidelines and that you agree to comply with the obligations therein.

**Signed:** .....

**Performer Stage Name:** .....

**Performer Full Name:** .....

**Date:** .....

# The Nags Head

## Performer Welfare Policy

- Each Performer will undergo a preliminary interview with Management and will provide two forms of identification, including a utility bill and photographic identification and, if appropriate, any proof of entitlement to work in the UK.
- During induction, the House Rules, Performer Welfare Policy and Performer Code of Conduct, together with a copy of any conditions on the Premises Licence and Sexual Entertainment Venue (SEV) Licence will be explained. The Performer will be required to sign and confirm their understanding of the above.
- Appropriate Health and Safety training will be provided in relation to the layout of the Premises and the procedures in case of emergency.
- Training will be provided in relation to working schedules, changing room etiquette, payments and charging, disciplinary procedures, customer relations and conflict management, incident reporting and arrival and exit procedures.
- Any Performer concerned about the behaviour of a Customer shall report the incident to Management or a Door Supervisor who will take immediate action to investigate and take appropriate action.
- Staff members must constantly supervise the behaviour of Customers at the Premises and shall intervene where any customer is breaching the "House Rules" or otherwise causing alarm or distress to a Performer.
- Performers shall be provided with free tap drinking water on request; there is no requirement for Performers to drink alcohol.
- Secure dressing room facilities are provided. Performers will use the dressing room facilities for changing before and after the performance period and for rest breaks as agreed with Management.
- There is a designated smoking area for Performers in the rear courtyard and whilst at the Premises, Performers may only smoke in this area.
- All areas of the Premises to which the public have access will have adequate supervision via CCTV and/or a SIA registered door supervisor.
- For their safety, Performers will be required to stay until the end of the

performance period and if required will be escorted by a Door Supervisor to their vehicle on departure from the Premises.

- Taxis can be provided for Performers on request in order to leave the Premises. There is no requirement for the Nags Head to pay the fare of such taxi.

### **Performer Declaration**

#### **I confirm that:**

- The Nags Head is not under any liability to make PAYE deductions on my behalf as I am not employed by the Nags Head.
- The onus is on me to make a return to HMRC and it is my obligation to pay any taxes due, including VAT and Income Tax. It is also my responsibility to ensure that I am not claiming any inappropriate benefits or allowances whilst performing on a self-employed basis at The Nags Head.
- I will not hold The Nags Head or any of their employees or other persons working at the premises on a self-employed basis responsible for acts or omissions arising out of my negligence, and I will be responsible for taking out any insurance to cover sickness, damage and loss.
- I confirm that I have declared any convictions for drugs or prostitution or other convictions below, and if required I will obtain a disclosure of my criminal record and show it to the manager.
- I have read, understood and agree to abide by the conditions of the Sexual Entertainment Venue Licence and Premises Licence.

#### **Disclosure of criminal convictions or if None please state "NONE"**

#### **Nature of Offence**

**Performer "Stage" Name:** .....

**Performer Full Name:** .....

**Home address:** .....

**Postcode:** .....

**Telephone number:** .....

**Date of birth:** .....

**Signature:** .....

**Date:** .....

# The Nags Head

## Performer Code of Conduct

- During a performance there shall be no full bodied physical contact between the Performer and the Customer other than the transfer of money or token at the beginning, during or conclusion of the dance.
- During the performance of a private dance Customers must remain seated and are not permitted to dance or otherwise participate in the performance other than as a spectator.
- Customers must remain appropriately clothed at all times. Neither Customer nor Performer may remove any of the Customer's clothing during a performance.
- If a Customer attempts to touch, or speak to a Performer inappropriately, the Performer must immediately stop the performance and explain the House Rules. If the Customer persists in the inappropriate behaviour, the Performer shall stop the performance and ask for assistance from the Management, who will take appropriate action, which may include escorting the Customer from the Premises.
- During a performance there shall be no full bodied physical contact between Performers and they are not to touch each other's genitalia and/or breasts.
- Performers shall not engage in an act of prostitution (the receiving of gratuities or payments for any form of sexual favour).
- Performers shall not solicit for gratuities or payment in return for sexual favours.
- Performers must redress at the conclusion of the performance.
- Performers must remain fully dressed while on the premises, except while performing in areas approved by the Council for sexual entertainment and in the approved changing rooms.
- Performers may only perform in the areas of the club designated by management.
- Performers must not give out any personal information, including telephone numbers, or contact details away from the premises.
- Performers must never be in the company of a customer except in an area open to the public within the premises.

# Appendix 9



# SEV Premises

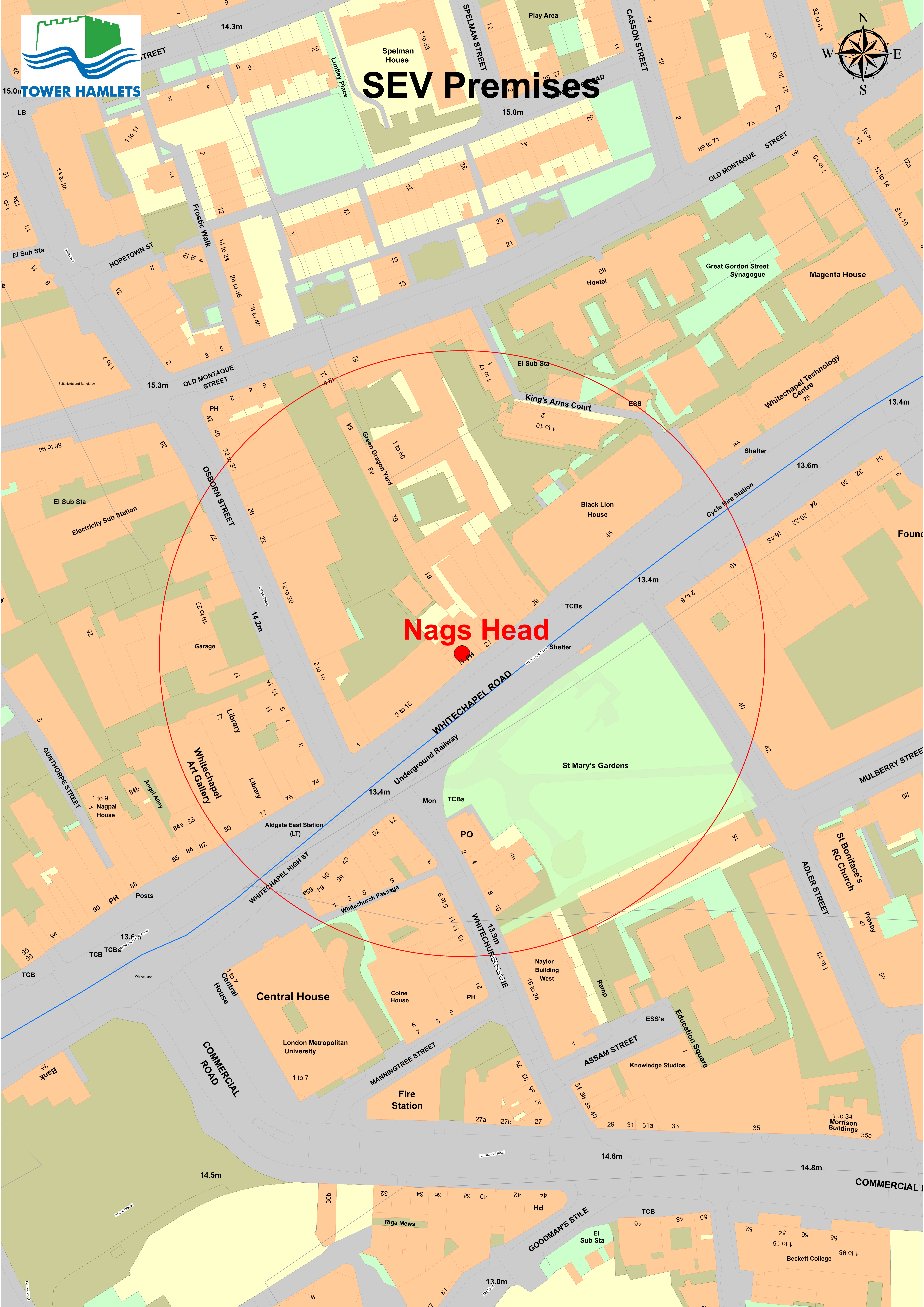
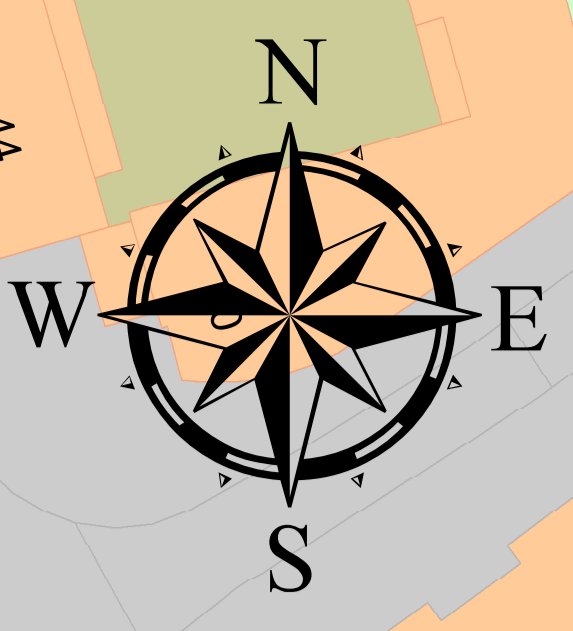

**Nags Head**

# Appendix 10



# Spitalfields and Banglatown Ward Profile

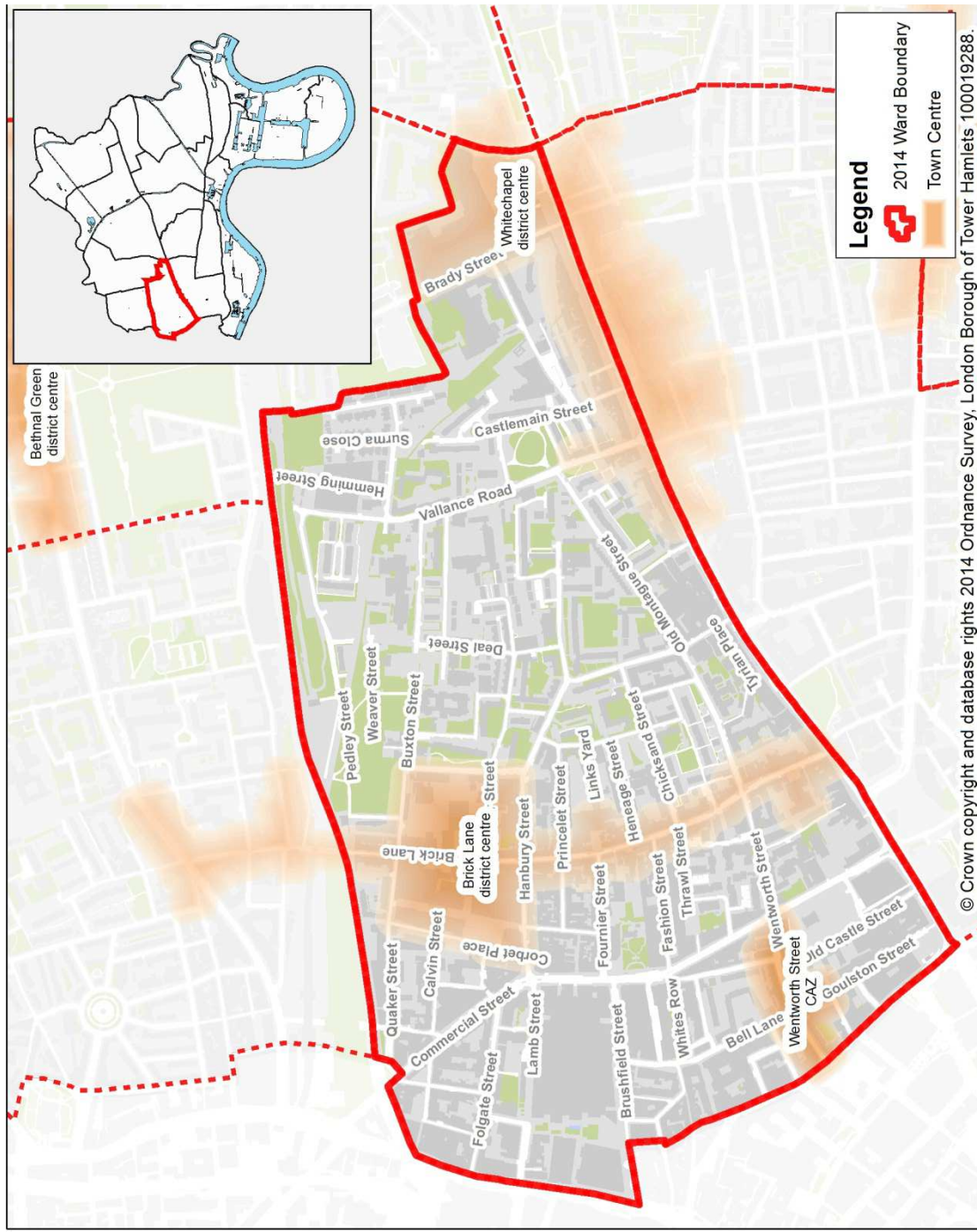

<b>Contents</b>	
Population.....	3
Ethnicity .....	4
Religion.....	4
Housing.....	5
Health - Limiting illness or disability .....	8
Unpaid care provision.....	8
Labour market participation .....	9
Socio economic groups .....	10
Qualification levels .....	11

## **Introduction**

The ward profiles have been produced for all 20 wards in Tower Hamlets. They provide the social, economic and demographic characteristics of each ward in the borough developing a broad picture of the area and help describing local differences.

In May 2014, the number of wards increased from 17 to 20. The changes were made by the Local Government Boundary Commission for England, in order to ensure that every councillor in Tower Hamlets represented roughly the same number of residents. The changes mean that no ward will have a population variance of greater than 10 per cent. As a result of the changes, the average population per councillor will be 4,029 in 2014, rising to 4,417 by 2018, according to projected population growth.

Data from the 2011 Census has been used throughout this ward profile as this still provides the single best source of statistics which are available at geography small enough to be aggregated up in to the new wards. While more recent estimates of the resident population are available for the borough and old ward boundaries, these cannot be used to infer the current population according to the new ward boundaries.

## Population

### Age Structure

Figure 1: Proportion of population by age

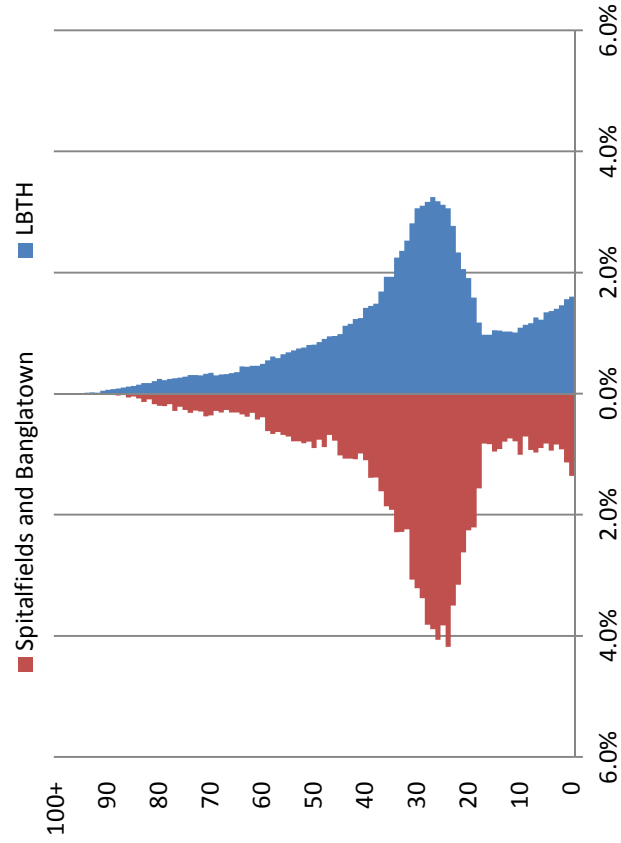

(Source: Census 2011 QS103EW - Age by single year)

Table 1: Number and proportion of residents by age range

Residents by Age	0-15	16-64	65+	Total
Spitalfields & Banglatown	1,853	10,073	652	12,578
Spitalfields & Banglatown %	14.7%	80.1%	5.2%	100%
Tower Hamlets %	19.7%	74.1%	6.1%	100%

(Source: Census 2011 QS103EW - Age by single year)

- At the time of the 2011 Census, the population for Spitalfields and Banglatown was 12,578 which accounted for almost 5 per cent of the total population of Tower Hamlets.
- The ward had 6,782 males and 5,796 females providing a gender split in the ward of 53.9 per cent male and 46.1 per cent female. This ward had almost a thousand more males than females.
- The population density in this ward was 145 people per hectare, higher than the borough average of 129 people per hectare.
- Just over 10,000 of the residents of Spitalfields and Banglatown ward were aged between 16-64 years old, accounting for 80.1 percent of the ward population. This proportion was the fourth highest in the borough. There were fewer than borough average residents aged 0-15 years old. The proportion was the third lowest compared to the rest of the borough.

## Ethnicity

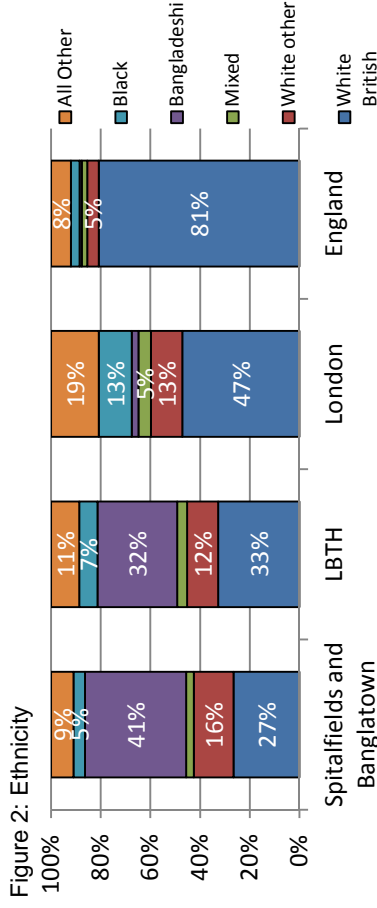

(Source: Census 2011 QS201EW - Ethnic group)

## Religion

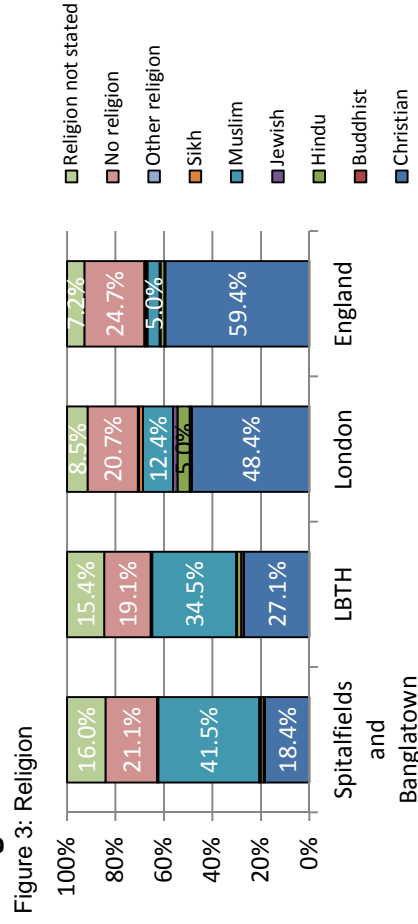

(Source: Census 2011 QS208EW – Religion)

- At the time of the 2011 Census, 7,235 residents in the ward were BME (58 per cent). This proportion was higher than the borough average of 54 per cent.
- Residents of Bangladeshi origin accounted for 41 per cent of the population (5,121 residents), a higher than the borough average.
- There were 3,346 White British residents in the Spitalfields and Banglatown ward. There was a lower proportion of residents who are White British in the ward compared to the borough average.
- The three largest ethnic groups in the borough (White British, Bangladeshi and White Other) accounted for 83 per cent of all residents in this ward.

- The proportion of residents who identified themselves as Christian was 18.4 per cent – lower than the borough average of 27.1 per cent. At 41.5 per cent of the population, the proportion of Muslim residents was higher than the borough average.
- 2,660 residents in the ward explicitly stated that they had no religion, this equated to 21.1 per cent of the ward population, compared to the borough average of 19.1 per cent.
- Tower Hamlets has a significantly higher proportion of residents who did not state their religion on the census form when compared to London and the rest of England. There were just over 2,000 residents in the ward who did not state their religion on the census form – accounting for 16 per cent of the ward's population, higher than the borough average.

## Housing Tenure<sup>1</sup>

Figure 4: Tenure of households



(Source: Census 2011 QS405EW - Tenure – Households)

## Household size

Figure 5: Tenure of households

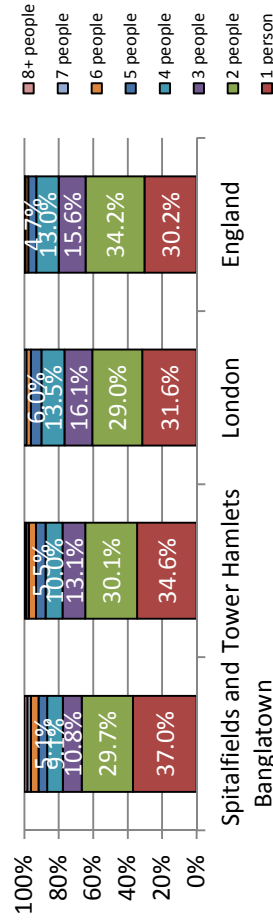

(Source: Census 2011 QS405EW - Tenure – Households)

- Tower Hamlets as a whole had a significantly lower proportion of households who were owner-occupier compared to the London average (26.6 per cent compared to 49.9 per cent). The proportion of socially rented households in the borough was almost double that of the London average. There was also a higher proportion of privately rented households compared to the London average.
- There were 4,747 households in the Spitalfields and Banglatown ward. Compared to the other wards, the ward had a lower than average proportion of households – accounting for nearly 4.7 per cent of the whole.
- 25.9 per cent of households in the wards were owner-occupied, a rate lower than the borough average of 26.6 per cent.
- There were a lower than average proportion of socially rented properties in this ward and a higher than average proportion of private rented properties. Together the proportion of renters (72.9 per cent) was below the borough average (72.2 per cent).

- The proportion of households in this ward with three or more people accounted for 33.3 per cent of the total households in the ward. This proportion was lower than the borough average of 35 per cent.
- On Census day, 633 households were recorded as having five or more people living in them. This equates to 13.3 per cent of the households in the ward and was higher than the average for Tower Hamlets (12.3 per cent).
- The average household size in the ward was 2.65 compared to the borough average of 2.51.

<sup>1</sup> Tenure provides information about whether a household rents or owns the accommodation that it occupies and, if rented, combines this with information about the type of landlord who owns or manages the accommodation.

**Household composition**

Figure 6: Household composition - percentage of households by type

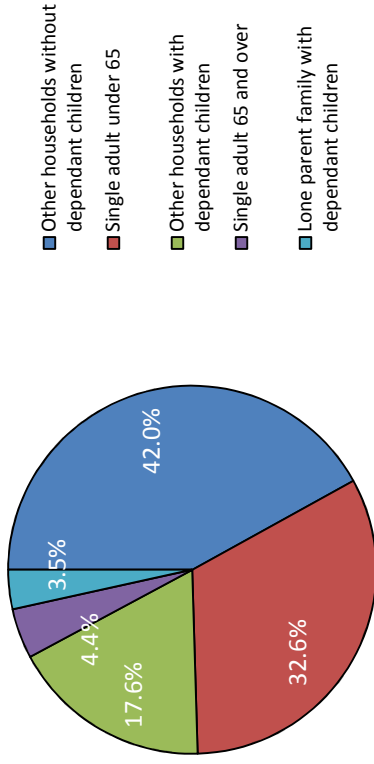

(Source: Census 2011 QS113EW - Household composition – Households)

- At the time of the Census, 42.9 per cent of all residents in the ward lived in family households with dependent children; this proportion was lower than the borough average of 46.2 per cent.
- However, families with dependent children occupied 21.1 percent of the households in the ward, lower than the borough average of 26.6 per cent.
- Single adult households accounted for 37 per cent of all households in the ward; however 14.8 per cent of the ward's residents lived in this type of household.
- Older people living alone (65+) accounted for 4.4 per cent of households which was lower than the borough average of 6 per cent.
- Table 3 shows the proportion of households that were overcrowded, had the required number of bedrooms, or were under-occupied at the time of the Census. 19 per cent of households (883 households) in the ward were overcrowded – higher than the average for the borough (16 per cent).

Figure 7: Household composition: percentage of residents that live in each household type

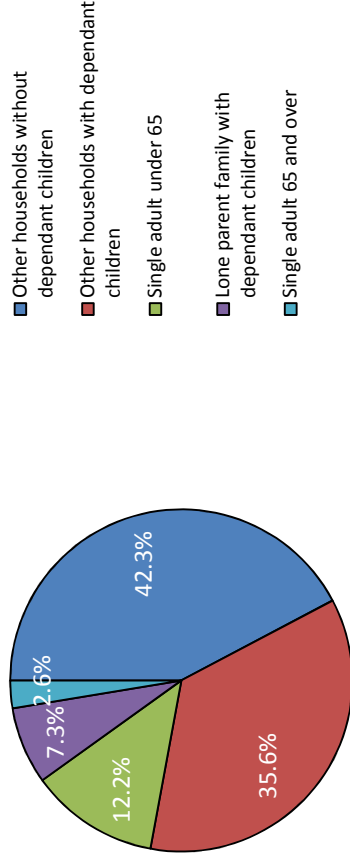

(Source: Census 2011 QS112EW - Household composition – People)

Table 2: Average household size

Average residents per household	Spitalfields and Banglatown	Tower Hamlets	London	England
Households with dependent children	4.81	4.30	3.89	3.78
Households with non-dependent children	1.85	1.81	1.84	1.78

(Source: Census 2011 QS406EW - Household size)

Table 3: Occupancy ratings

Area	Overcrowded (-1 or less)	Required Bedrooms (0)	Under Occupied (+1 or more)
Spitalfields & Banglatown	883	2,526	1,338
Tower Hamlets	16,605	51,058	33,594
London	370,531	1,282,883	1,612,759
England	1,024,473	5,885,951	15,152,944
	5%	27%	69%

(Source: Census 2011 QS406EW - Household size)

## Health - Limiting illness or disability

Table 4: Limiting illness and disability

Area	Day-to-day activities limited a lot	Day-to-day activities limited a little	Day-to-day activities not limited
Spitalfields & Banglatown	853	893	10,832
Spitalfields & Banglatown (%)	6.8%	7.1%	86.1%
Tower Hamlets (%)	6.8%	6.7%	86.5%
London (%)	6.7%	7.4%	85.8%
England (%)	8.3%	9.3%	82.4%

(Source: Census 2011 QS303EW - Long-term health problem or disability)

- On Census day, around 853 residents (8.1 per cent) in Spitalfields and Banglatown had a long term health problem or disability *limiting the persons day to day activities a lot*, while 7.1 per cent (893 residents) had a long term health problem or disability *limiting the persons day to day activities a little*.
- In Spitalfields and Banglatown, the rate of people with a long term health problem or disability *limiting day to day activities a lot* was resembling the Tower Hamlets (6.8 per cent) and London rate (6.7 per cent) but was below the England rate.
- In comparison, the rate of people with a long term health problem or disability *limiting day to day activities a little* of 7.1 per cent was above the Tower Hamlets (6.7 per cent) but below the London and England average.

## Unpaid care provision

Table 5: Unpaid care provision

Area	Provides no unpaid care	Provides 1 to 19 hours unpaid care a week	Provides 20 to 49 hours unpaid care a week	Provides 50 or more hours unpaid care a week
Spitalfields & Banglatown	11,702	494	170	212
Spitalfields & Banglatown (%)	93.0%	3.9%	1.4%	1.7%
Tower Hamlets (%)	92.4%	4.3%	1.4%	1.9%
London (%)	91.6%	5.3%	1.3%	1.8%
England (%)	89.8%	6.5%	1.4%	2.4%

(Source: Census 2011 QS301EW - Provision of unpaid care)

- Around 7 per cent of residents in Spitalfields and Banglatown provided unpaid care. The Spitalfields and Banglatown rate was below the Tower Hamlets (7.6 per cent), London (8.4 per cent) and England (10.2 per cent) rates.
- From 876 residents in Spitalfields and Banglatown who provided unpaid care, 170 residents provided care for 20 to 49 hours a week, while 212 residents provided care for 50 or more hours a week.
- The proportion of those providing unpaid care for 50 hours or more of 1.7 per cent in Spitalfields and Banglatown was below Tower Hamlets (1.9 per cent), London (1.8 per cent) and England (2.4 per cent) averages.



## Labour market participation

Table 6: Labour market participation - Economic active (EA) and Economic Inactive (EI) (totals and %)

Area	EA: In employment	EA Unemployed	EA: Full-time student	EI: Retired	EI: Student (incl. full-time)	EI: Looking after home / family	EI: Long-term sick or disabled	EI: Other
Spitalfields & Banglatown	5,660	780	639	446	1,323	642	489	485
Spitalfields & Banglatown (%)	54.1	7.5	6.1	4.3	12.6	6.1	4.7	4.6
Tower Hamlets (%)	57.6	6.7	5.5	4.7	9.9	7.0	4.5	4.0
London (%)	62.4	5.2	4.1	8.4	7.8	5.2	3.7	3.2
England (%)	62.1	4.4	3.4	13.7	5.8	4.4	4.0	2.2

(Source: Census 2011 KS601EW to KS603EW - Economic activity by sex, Population 16 to 74)

- Table 6 shows a summary of labour market participation of residents in the week before the Census 2011. The table summarises economic activity and inactivity of the 16 to 74 population in Spitalfields and Banglatown and comparator areas.
  - Spitalfields and Banglatown had a rate of 54.1 per cent of residents in employment, slightly below Tower Hamlets (57.6 per cent) and London (62.4 per cent) averages.

- The proportion of economically inactive residents, including those looking after home & family (6.1 per cent) and the long term sick (4.7 per cent) was above the borough, London and England averages.
- A total of 780 residents were unemployed in Spitalfields and Banglatown. The rate of 7.5 per cent was above the Tower Hamlets (6.7 per cent), London (5.2 per cent) and England (4.4 per cent) averages. Interestingly, the proportion of students, both economically active students (6.1 per cent) and inactive students (12.6 per cent) was above the Tower Hamlets, London and England rates too.

### Unemployment rate of 16 to 64 (economic active population only)

- Figure 8 on the right shows the unemployment rate based on the economically active population only. This measure is the better unemployment measure but it is in general higher compared to the rate based on the proportion of all residents in the 16 to 74 age group as shown above.
- Spitalfields and Banglatown had the 10<sup>th</sup> highest unemployment rate in the borough with 13.8 per cent, nearly 1.8 percentage points above the Tower Hamlets rate (12 per cent).
- On Census day, the highest unemployment rate was recorded in Lansbury (18.8 per cent) and the lowest in St Katharine's and Wapping with only 4.9 per cent.

Figure 8: Unemployment rate of 16 to 64 – economic active population only

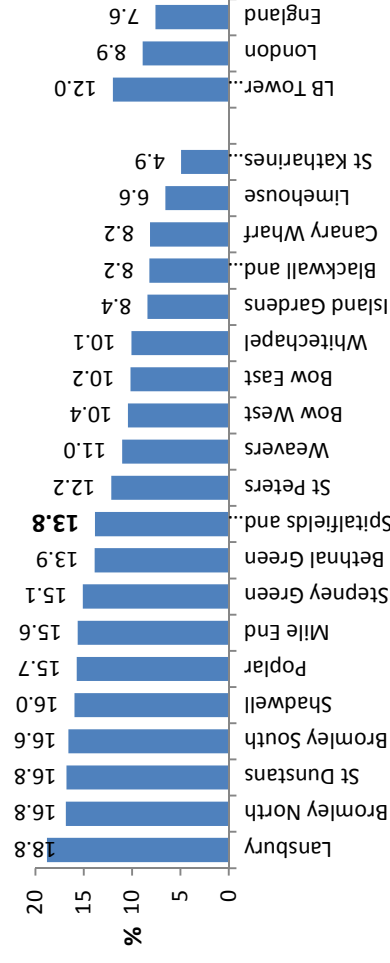

(Source: Census 2011: QS601EW - Economic activity)

## Socio economic groups

Figure 9: Socio Economic Groups

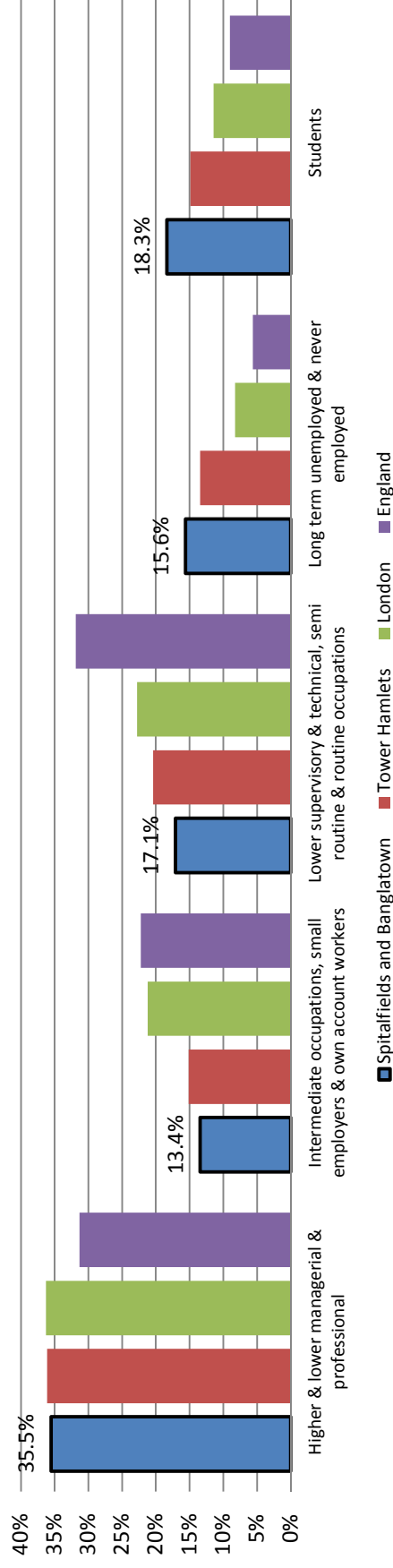

(Source: Census 2011 QS607EW - NS-SeC)

- At the time of the Census, there was a higher proportion of working aged residents working in managerial and professional occupations than any other sector. However at 35.5 per cent, the ward had a slightly lower proportion of residents in this category than the borough average (36.1 per cent).
- There was a higher than borough average proportion of residents in this ward who were classified as long term unemployed / never employed (15.6 per cent compared to 13.5 per cent). There were 1,632 ward residents in this category).
- The ward had a higher than average proportion of residents classified as students compared to the borough average of 14.9 per cent.

## Qualification levels

Table 7: Highest qualification of residents aged 16 to 64

Area	No qualification	Level 1	Level 2	Apprenticeship	Level 3	Level 4 And above	Other
Spitalfields & Banglatown	1,491	919	825	61	1,164	4,524	1,089
Spitalfields & Banglatown (%)	14.8	9.1	8.2	0.6	11.6	44.9	10.8
Tower Hamlets (%)	15.6	9.8	9.2	0.8	10.8	43.6	10.2
London (%)	12.4	11.5	12.6	1.4	11.5	40.5	10.0
England (%)	14.8	15.2	17.1	3.1	14.5	29.8	5.6

(Source: Census 2011 LC5102EW - Highest level of qualification by age)

- The population aged 16 to 64 in Spitalfields and Banglatown showed a qualification structure close to the Tower Hamlets average.
- The proportion of those with a level 4 qualification was just above the borough average with 44.9 per cent but was also above London (40.5 per cent) and England (29.8 per cent) rates.
- Around 1,491 residents (14.9 per cent) aged 16 to 64 did not hold a formal qualification. This rate was just below the Tower Hamlets average of 15.6 per cent.

The lowest proportion of residents with no qualification was recorded in St Katharine's and Wapping ward (6.8 per cent) while the highest proportion with no qualification was in the Lansbury ward with 25.6 per cent.

- The proportion of Spitalfields and Banglatown residents with a level 3 qualification was 11.6 per cent, a rate slightly above the Tower Hamlets figure (10.8 per cent).
- Level 1 and Level 2 qualification rates in Spitalfields and Banglatown were slightly lower than the borough rates.

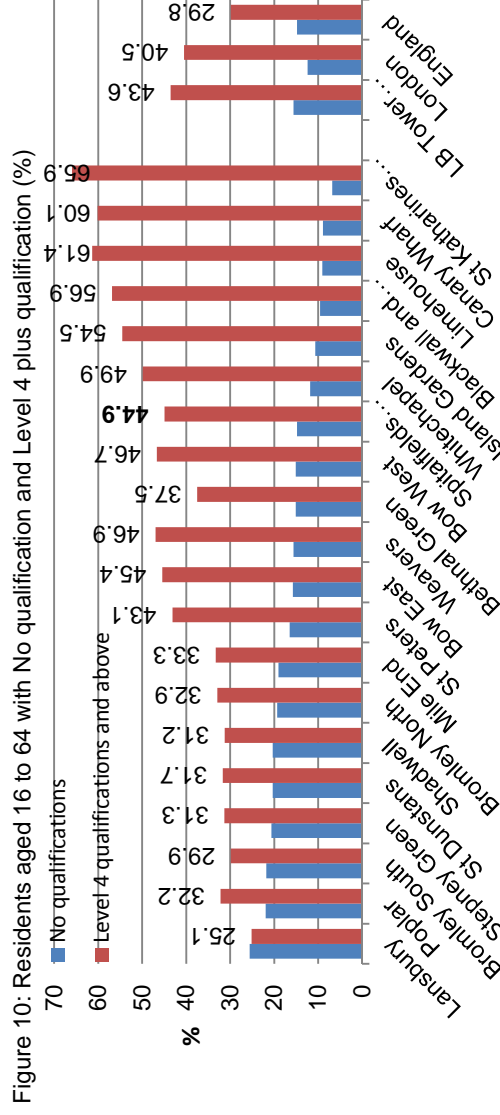

(Source: Census 2011 LC5102EW - Highest level of qualification by age)

## Spitalfields and Banglatown Statistical Area

**Statistical Areas**

The map (right) shows which Census Output Areas have been included in the summary statistics for this ward, and which areas have been assigned to other wards.

Census Output Area (OA) data has been aggregated on a best fit basis to match the new Tower Hamlets ward boundaries as closely as possible. This has been done in accordance with methodology employed by the Office for National Statistics (ONS) in producing census statistics for non-standard geographies. Details of this methodology can be found on the ONS website at: <http://www.ons.gov.uk/ons/guide-method/geography/geographic-policy/best-fit->

### Spitalfields and Banglatown and the old wards

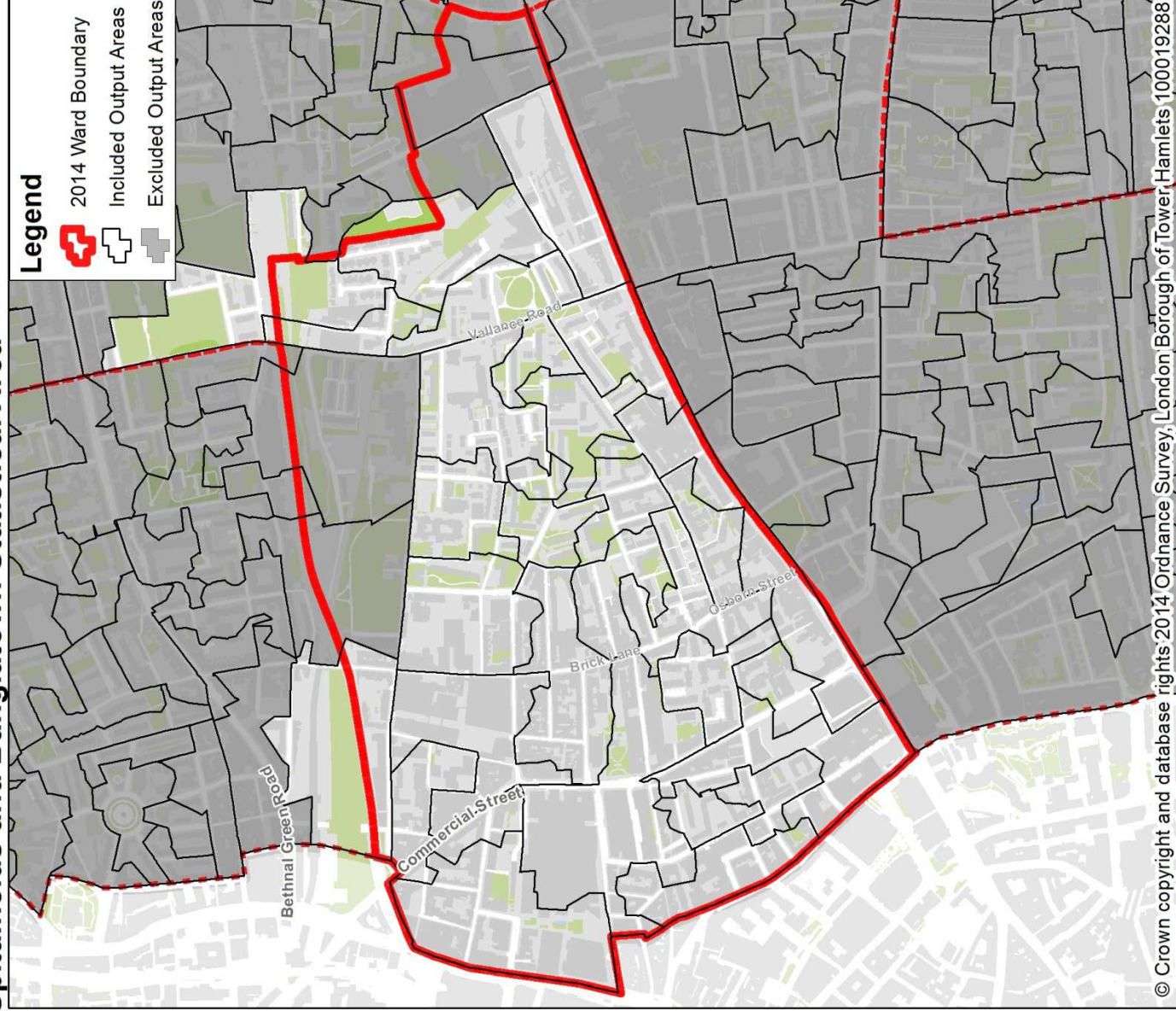
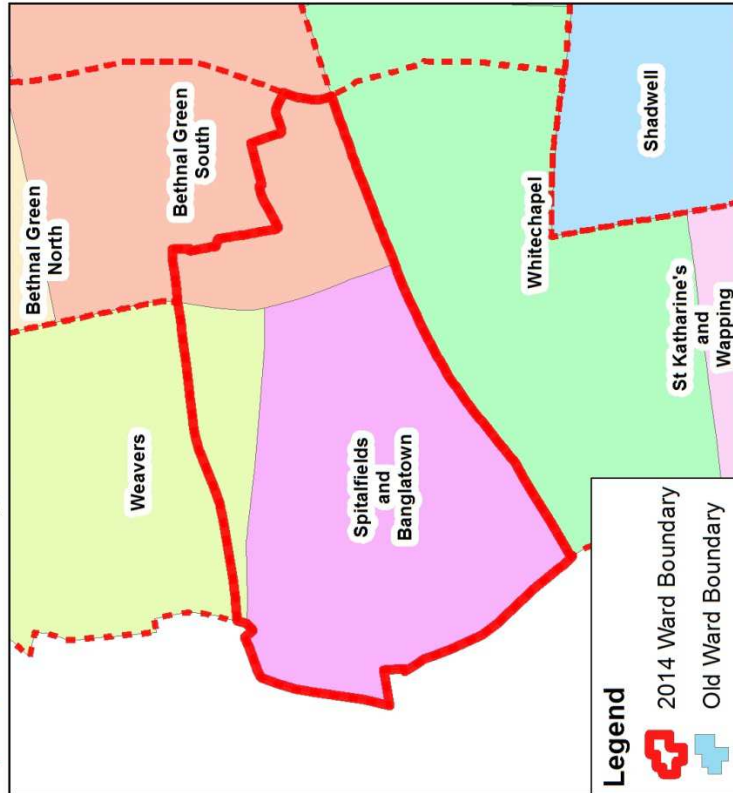

© Crown copyright and database rights 2014 Ordnance Survey, London Borough of Tower Hamlets 100019288.

### **Further information**

The data used in this document has been sourced from the Office for National Statistics Census 2011 and specific Census 2011 data tables are quoted in the document.

**Contact the Corporate Research Unit: [cru@towerhamlets.gov.uk](mailto:cru@towerhamlets.gov.uk)**

For more information, see the [Borough Profile](#) page on the council's internet. Census 2011 data tables can be obtained from the [Office for National Statistics](#) official labour market statistics webpage.

# Appendix 11



**LOCAL GOVERNMENT (MISCELLANEOUS PROVISIONS) ACT 1982  
(as amended)**

Notice of Application for the ~~ISSUE~~ / Renewal of a Sexual Entertainment Venue  
*\*delete as appropriate*

TAKE NOTICE THAT ON:

By: MANPAL / KARPAL + SHAMSHER *(insert name of applicant)*

SINGH

Of: 17-19 WHITECHAPEL ROAD *(insert address of applicant)*  
LONDON E1 1DU

Made application to London Borough of Tower Hamlets for the ~~ISSUE~~ / renewal of a licence to use the premises named below as a Sexual Entertainment Venue.

Address of Premises:	THE NAGS HEAD 17-19 WHITECHAPEL ROAD LONDON E1 1DU
----------------------	--

Description and detail of sexual entertainment to be provided including times of operation:	FULLY NUDE STRIPEASE 11:00 - 03:00 THE DAY FOLLOWING ON MONDAY TO SATURDAYS + 12:00 - 22:30 ON SUNDAYS
---	---

Any objections to this application shall be made not later than 16/6/2016 which is 28 days after the above date of the application. Objections must be made in writing, stating in general terms the grounds for objection to:

The Licensing Section, London Borough of Tower Hamlets, 6th Floor, Mulberry Place,  
London E14 2BG or [licensing@towerhamlets.gov.uk](mailto:licensing@towerhamlets.gov.uk) Website: [www.towerhamlets.gov.uk](http://www.towerhamlets.gov.uk)  
Tel: 020 7364 5008

Please note: Objections must be made in writing and shall contain the name and address of the objector. Such objections will be sent to the applicant and will become public documents, however, personal details such as name, address and telephone number will be removed.

# Appendix 12





PUBLIC NOTICES

## Legal and Public Notices

**LOCAL GOVERNMENT  
(MISCELLANEOUS PROVISIONS) ACT 1982  
(AS AMENDED)**
**Notice of Application for the Renewal of a Sexual  
Entertainment Venue**

Take notice that we, Manpal/Karpal & Shamsher Singh of 17-19 Whitechapel Road, London, E1 1DU made application to London Borough of Tower Hamlets for the renewal of a licence to use the premises named below as a Sexual Entertainment Venue. Address of the Premises: The Nags Head, 17-19 Whitechapel Road, London, E1 1DU. Description and detail of sexual entertainment to be provided including times of operation: Fully nude striptease, 11:00 - 03:00 the day following on Monday to Saturdays & 12:00 - 22:30 on Sundays. Any objections to this application shall be made not later than 16 June 2016 which is 28 days after the above date of the application. Objections must be made in writing, stating in general terms the grounds for objection to: The Licensing Section, London Borough of Tower Hamlets, 6th Floor, Mulberry Place, London, E14 2BG or licensing@towerhamlets.gov.uk. Website: www.towerhamlets.gov.uk or Tel: 020 7364 5008. Please note: Objections must be made in writing and shall contain the name and address of the objector. Such objections will be sent to the applicant and will become public documents, however, personal details such as name, address and telephone number will be removed.

**LONDON BOROUGH OF TOWER HAMLETS  
PLANNING (LISTED BUILDINGS AND CONSERVATION  
AREAS) ACT 1990, SECTIONS 10, 67 AND 73**
**APPLICATIONS FOR LISTED BUILDING CONSENT AND  
APPLICATIONS FOR DEVELOPMENT WHICH WOULD IN  
THE OPINION OF THE LOCAL PLANNING AUTHORITY  
AFFECT THE CHARACTER OR APPEARANCE OF AN  
AREA DESIGNATED AS A CONSERVATION AREA OR  
WOULD AFFECT THE SETTING OF A LISTED BUILDING.**

43A Commercial Street, London, E1 6BD PA/16/01160 & PA 16/01161  
Installation of three air conditioning condensers.

Link House, 195 Bow Road, London PA/16/01169  
Removal of existing bin enclosures and external platform lift and creation of new secure bin area, cycle storage enclosure and front access gate.

813 Commercial Road, London, E14 7HG PA/16/00687  
Partial demolition and enlargement of existing first floor structures and construction of 2 additional residential floors above.

Flat 568, Manhattan Building, Fairfield Road, London, E3 2UL PA/16/01145

The proposed works include: the removal and repositioning of internal stud partition walls and the refurbishment of the bathroom, kitchen/living area and upper floor mezzanine level.

162 Brick Lane, London, E1 6RU PA/16/00852  
Retrospective permission for Installation of ATM.

7 Bellevue Place, London, E1 4UG PA/16/01143  
Replacement of existing sash windows with new sash windows.

5 Arbour Square, London, E1 0SH PA/16/01138 & PA/16/01139  
Internal and external works to grade II listed building, including removal of internal partition walls and changes to internal layout of the building.

386 Roman Road, London, E3 5QJ PA/16/01123  
Formation of Mansard room in the roof extension and rear roof terrace to outrigger, together with rear ground floor lean-to kitchen extension and first floor extension to outrigger.

45 Alderney Road, London, E1 4EG PA/16/00579  
Proposed mansard roof with internal loft conversion and associated windows at rear and front, replacement of rear ground floor double doors with bi-folding doors.

The application and supporting drawings may be viewed electronically at the Planning Office between 9am and 1pm Mondays to Fridays. Paper files are available for major applications only. You can visit between these times without making an appointment and a planner will be available to help with any general enquiries. The information will also be available on the Council's web site at <https://development.towerhamlets.gov.uk>. If you respond by email, please tell us your postal address.

Any person who wishes to make representations relating to any of these applications should do so, in writing, within a period of 21 days from the date of publication of this notice to the Development Control Manager at:

Tower Hamlets Planning Department, Mulberry Place, 5 Clove Crescent, London E14 2BG email: development.control@towerhamlets.gov.uk

Dated: 26th May 2016

OWEN WHALLEY  
Head of Planning and Building Control

**LONDON BOROUGH OF TOWER HAMLETS  
LICENSING ACT 2003  
NOTICE OF APPLICATION FOR  
A PREMISES LICENCE**

Notice is given that Oki-Doki Nails Limited has applied to London Borough of Tower Hamlets Licensing Authority for a Premises Licence under the Licensing Act 2003.

Premises: Unit 3, Westward Parade, Pepper Street, London E14 9DZ

**The licensable activities and timings are:**

Sale of alcohol within the hair salon to customers. A small Champagne Bar is proposed within the hair salon, Monday to Saturday 10am to 7pm, Sunday 12 noon to 5pm.

Anyone who wishes to make representations regarding this application must give notice in writing to: The Licensing Section, London Borough of Tower Hamlets, Mulberry Place, 5 Clove Crescent, London, E14 2BG Website: www.towerhamlets.gov.uk Tel: 020 7364 5008 Representations must be received no later than 16/06/2016

The Application Record and Register may be viewed between 10am and 4pm Monday to Friday during normal office hours at the above address.

*It is an offence under Section 158 of the Licensing Act 2003, knowingly or recklessly to make a false statement in connection with an application and the maximum fine for which a person is liable on summary conviction for the offence is up to level 5 on the standard scale (£5000).*

**SPECIAL TREATMENT LICENCE**

NOTICE IS GIVEN THAT LAN SI has applied to the London Borough of Tower Hamlets for a MANICURE licence for the premises HOUSE OF NAILS, 4 GROVE ROAD, MILE END, LONDON, E3 5AX

Anyone wishing to oppose the application must give notice in writing to David Tolley, Head of Consumer and Business Regulations Service, 6th Floor, Mulberry Place, 5 Clove Crescent, London E14 2BG WITHIN THREE WEEKS specifying the grounds of opposition.

Persons objecting to the grant of a licence must be prepared to attend in person at a hearing before a Committee of the Council.

jobs24.co.uk

**LONDON BOROUGH OF TOWER HAMLETS  
LICENSING ACT 2003  
NOTICE OF APPLICATION FOR  
A PREMISES LICENCE**

Notice is given that Guillaume Sanzey (General Manager at Plateau) has applied to London Borough of Tower Hamlets Licensing Authority for a Premises Licence under the Licensing Act 2003.

Premises: Plateau Restaurant, 4th Floor Canada Place, Canary Wharf, E14 5ER / 02077157100

**The licensable activities and timings are:**

Plateau restaurant in Canary Wharf will be launching a pop-up summer bar; selling cold alcoholic and non-alcoholic beverages in Canada Square Park; from mid-June to 31st September, 7 days per week, 11am to 11pm with the authorisation of Canary Wharf Group Plc.

Anyone who wishes to make representations regarding this application must give notice in writing to: The Licensing Section, London Borough of Tower Hamlets, Mulberry Place, 5 Clove Crescent, London, E14 2BG Website: www.towerhamlets.gov.uk Tel: 020 7364 5008

Representations must be received no later than 21/06/16

The Application Record and Register may be viewed between 10am and 4pm Monday to Friday during normal office hours at the above address.

*It is an offence under Section 158 of the Licensing Act 2003, knowingly or recklessly to make a false statement in connection with an application and the maximum fine for which a person is liable on summary conviction for the offence is up to level 5 on the standard scale (£5000).*

**Goods Vehicle  
Operator's Licence**

ASQ International Ltd, trading as ASQ International Ltd, of Stand 60a, New Spitalfields Market, 1 Sherrin Road, London E10 5SQ is applying for a licence to use Secure Self Storage, Old Gas Works, Leven Road, Poplar, London E14 0LL as an operating centre for 2 goods vehicles, and 2 trailers.

Owners or occupiers of land (including buildings) near the operating centre(s) who believe that their use or enjoyment of that land would be affected, should make written representations to the Traffic Commissioner at Hillcrest House, 386 Harehills Lane, Leeds, LS9 6NF, stating their reasons, within 21 days of this notice. Representors must at the same time send a copy of their representations to the applicant at the address given at the top of this notice. A Guide to Making Representations is available from the Traffic Commissioner's office.

**LONDON BOROUGH OF TOWER HAMLETS  
TOWN AND COUNTRY PLANNING ACT 1990  
(AS AMENDED)**
**TOWN AND COUNTRY PLANNING  
(ENVIRONMENTAL IMPACT ASSESSMENT)**
**REGULATIONS 2011 (AS AMENDED) - Regulation 22**

Reference: PA/15/02959 Application received: 19/10/2015

Proposed development of land at: Site between Varden Street and Ashfield Street (Whitechapel Estate), London, E1

**Proposed development:** Demolition of all existing buildings and redevelopment to provide 12 buildings ranging from ground plus 2 - 23 storeys (a maximum 94m AOD height), comprising 343 residential dwellings (class C3), 168 specialist accommodation units (Class C2), office floorspace (class B1), flexible office and non-residential institution floorspace (Class B1/D1), retail floorspace (class A1 - A3), car parking, cycle parking, hard and soft landscaping and other associated works.

This application is accompanied by an Environmental Impact Assessment.

**AMENDED DESCRIPTION:** Follows a proposed reduction in the total number of residential dwellings (Class C3) and an increase in the specialist accommodation (Class C2). The changes do not impact upon the external size/massing of the building envelopes to the proposed 12 buildings.

**I give notice that DP9 on behalf of London Newcastle on behalf of Cross Property Investment SARM and Cross Propert has submitted 'further information' supplementing the Environmental Statement in relation to the above application, to the London Borough of Tower Hamlets Mulberry Place, 5 Clove Crescent, London E14 2BG.**

The Environmental Statement and 'further information' is available for viewing by members of the public at all reasonable hours at the Council offices (address as below), and also on the Council's web site at www.towerhamlets.gov.uk. The Council offices are open for the public - Monday to Friday 9am to 1pm. The latest date that this will be available for inspection will be: 16/06/2016

Copies of the 'further information' may be obtained at a charge from the Council offices (address as below) - copies may be obtained so long as stocks last. The charge for copies is provided on the Council's website: [http://www.towerhamlets.gov.uk/lgs/451-500/485\\_planning\\_applications/planning\\_application\\_fees\\_and.aspx](http://www.towerhamlets.gov.uk/lgs/451-500/485_planning_applications/planning_application_fees_and.aspx)

Any person who wishes to make representations regarding the application and the additional information should write to the London Borough of Tower Hamlets Planning Service at Development & Renewal, Town Hall, Mulberry Place, 5 Clove Crescent, London E14 2BG within 21 days beginning with the date of this notice.

Dated: 26th May 2016

Paul Buckenham - Development Manager  
On behalf of the London Borough of Tower Hamlets Council

**LONDON BOROUGH OF TOWER HAMLETS  
TOWN & COUNTRY PLANNING ACT 1990**
**MAJOR APPLICATIONS UNDER ARTICLE 15(4) OF THE  
TOWN AND COUNTRY PLANNING (DEVELOPMENT  
MANAGEMENT PROCEDURE) ORDER 2015 AND OTHER  
SIGNIFICANT APPLICATIONS.**

Notice is hereby given that the London Borough of Tower Hamlets is considering the following applications:

1 Greenwich View Place, London, E14 9NN PA/16/01026

Demolition of existing data centre buildings and the erection of a single 3 storey data centre building landscaping, roof level plant and associated works; erection of an enclosed elevated pedestrian link

The application and supporting drawings may be viewed electronically at the Planning Office between 9am and 1pm Mondays to Fridays. Paper files are available for major applications only. You can visit between these times without making an appointment and a planner will be available to help with any general enquiries. The information will also be available on the Council's web site at <https://development.towerhamlets.gov.uk>. If you respond by email, please tell us your postal address.

Any person who wishes to make representations relating to any of these applications should do so, in writing, within a period of 14 days from the date of publication of this notice to the Development Control Manager at:

Tower Hamlets Planning Department, Mulberry Place, 5 Clove Crescent, London E14 2BG email: development.control@towerhamlets.gov.uk

Dated: 26th May 2016

OWEN WHALLEY  
HEAD OF PLANNING & BUILDING CONTROL

Reach **YOUR** local  
audience by advertising  
in **YOUR** local paper.

Call the team now on  
**0845 671 4460**

**Transport for London Public Notice**
**ROAD TRAFFIC REGULATION ACT 1984**
**THE A13 GLA ROAD (COMMERCIAL ROAD,  
LONDON BOROUGH OF TOWER HAMLETS)  
(TEMPORARY BANNED TURNS) ORDER 2016**

- Transport for London hereby gives notice that it has made the above named Traffic Order under section 14(1) of the Road Traffic Regulation Act 1984 for the purpose specified in paragraph 2. The effect of the Order is summarised in paragraph 3.
- The purpose of the Order is to prohibit vehicles from making certain movements on A13, Commercial Road because of the likelihood of danger to the public.
- The effect of the Order will be to prohibit any vehicle proceeding on A13 Commercial Road, at its junctions with Settle Street and Christian Street to:
  - (1) Eastbound - turn right into Christian Street.
  - (2) Westbound - turn right into Settle Street.

The Order will be effective at certain times from 12:01 AM on the 28th May 2016 until 11:59 PM on 3rd July 2016 or when the works have been completed whichever is the sooner. The prohibition will apply only during such times and to such extent as shall from time to time be indicated by traffic signs.
- The prohibitions will not apply in respect of:
  - (1) any vehicle being used for the purposes of those works or for fire brigade, ambulance or police purposes;
  - (2) anything done with the permission or at the direction of a police constable in uniform or a person authorised by Transport for London.

At such times as the prohibition is in force an alternative route will be indicated by traffic signs via:

**For eastbound** vehicles wishing to turn right into Settle Street: A13 Commercial Road, Adler Street, Coke Street, Greenfield Street and to the normal route of travel

**For westbound** vehicles wishing to turn right into Christian Street: A13 Commercial Road, Hassel Street, Burslem Street and to the normal route of travel

Dated this 26th day of May 2016

Mark Whitaker  
Head Of Operation  
Transport for London  
Palestra, 197 Blackfriars Road, London, SE1 8NJ

MAYOR OF LONDON



TRANSPORT  
FOR LONDON

# Appendix 13

## Appendix One

### **Tower Hamlets Council**

#### **Sex Establishment Licensing Policy**

##### **Introduction**

This policy sets out Tower Hamlets Council's proposed approach to regulating sex establishments and the procedure that it will adopt in relation to applications for sex establishment licences.

The policy of the Council is to refuse applications for sexual entertainment venues. This policy is intended to be strictly applied and will only be overridden in genuinely exceptional circumstances. Such circumstances will not be taken to include the quality of the management, its compliance with licence conditions, the size of the premises or its operating hours.

The policy is intended as a guide to applicants, licence holders, people who want to object to applications and members of the Licensing Committee who are responsible for determining contested applications. It also aims to guide and reassure the public and other public authorities, ensuring transparency and consistency in decision making.

When the decision making powers of the Council are engaged each application will be dealt with on its own merits but this policy gives prospective applicants an early indication of whether their application is likely to be granted or not. It also provides prospective applicants details of what is expected of them should an application be made.

The legal controls for sex establishment premises are contained in the Local Governmental (Miscellaneous Provisions) Act 1982 as amended by the Policing and Crime Act 2009.

There are 3 types of sex establishments which fall into the licensing regime:-

Sex shops

Sex cinemas

Sexual entertainment venues

The role of the Council in its position as Licensing Authority is to administer the licensing regime in accordance with the law and not in accordance with moral standing. The Council recognises that Parliament has made it lawful to operate a sex establishment and such businesses are a legitimate part of the retail and leisure industries.

### **Policy Rationale**

The policy has been developed that sets out how the legislation will be administered and applied. The policy identifies how the Council would exercise the licensing regime in relation to sexual entertainment venues.

The policy has been developed to reflect and complement existing Council plans and strategic approach, namely:-

- Tower Hamlets Community Plan.
- Tower Hamlets Crime & Drug Reduction Partnership Plan.
- Tower Hamlets Enforcement Policy.
- Tower Hamlets Core Strategy.
- Tower Hamlets Town Centre Spatial Strategy.
- Tower Hamlets Statement of Licensing Policy (Licensing Act 2003).
- Tower Hamlets Statement of Licensing Policy (Gambling Act 2005).

The policy has also been prepared with regard to:

- Consultation responses
- Human Rights Act 1998
- Equalities Act 2010

The policy seeks to contribute to the “One Tower Hamlets” principle by fostering community cohesion, reducing inequalities and empowering communities. The public consultation that was undertaken concerning the adoption of a nil policy did not have overwhelming support. Therefore careful consideration has been given to the policy response, given the balance that the consultation returns did not give overwhelming support.

## Policy Considerations

### Existing Licensed Premises

The Council has had the ability to licence sex shops and sex cinemas under the Local Government (Miscellaneous Provisions) Act 1982 for many years.

There are no licensed sex shops in Tower Hamlets.

The businesses that hold premises licences under the Licensing Act 2003 with permissions that will be affected by the adoption of the sexual entertainment venue licensing regime are as follows:-

NAME	ADDRESS
THE BEEHIVE	104-106 Empson Street, London, E3 3LT
EONE CLUB	168 Mile End Road, London, E1 4LJ
NAGS HEAD PUBLIC HOUSE	17-19 Whitechapel Road, London, E1 1DU
THE PLEASURE LOUNGE	234 Cambridge Heath Road, London, E2 9NN
WHITE SWAN	556 Commercial Road, London, E14 7JD
ASTON'S CHAMPAGNE AND WINE BAR BASEMENT & 1ST FLOOR	187 Marsh Wall, London, E14 9SH
CLUB PAISA	28 Hancock Road, London, E3 3DA
OOPS	30 Alie Street, London, E1 8DA
WHITE'S GENTLEMANS CLUB	32-38 Leman Street, London, E1 8EW
SECRETS	43-45 East Smithfield, London, E1W 1AP
IMAGES	483 Hackney Road, London, E2 9ED

Tower Hamlets Council has adopted schedule 3 Local Government (Miscellaneous Provisions) Act 1982 with effect from 1<sup>st</sup> June 2014 so that it can:

- set a limit on the number of sexual entertainment venues
- determine premises that are appropriate for the borough and
- licence sexual entertainment venues

Sexual entertainment venues are those that regularly provide lap dancing and other forms of live performance or live display of nudity.

Establishments that hold events involving full or partial nudity less than once a month may be exempt from the requirements to obtain a sex establishment licence and applicants are advised to contact the Licensing Team for advice.

### **Limits on the number of licensed premises**

The Council has determined that there are a sufficient number of sex shops, sex cinemas and sexual entertainment venues currently operating in the borough and it does not want to see an increase in the numbers of premises that are currently providing these activities.

The Council intends to adopt a policy to limit the number of sexual entertainment venues in the borough to nil however it recognises that there are a number of businesses that have been providing sexual entertainment in Tower Hamlets for several years. The Council will not apply this limitation when considering applications for premises that were already trading with express permission for the type of entertainment which is now defined as sexual entertainment on the date that the licensing provisions were adopted by the authority if they can demonstrate in their application:

- High standards of management
- A management structure and capacity to operate the venue
- The ability to adhere to the standard conditions for sex establishments

The Council will consider each application on its merit although new applicants will have to demonstrate why the Council should depart from its policy. Furthermore if any of the existing premises cease trading there is no presumption that the Council will consider any new applications more favourably.

### **Location of premises**

The Council's policy is that there is no locality within Tower Hamlets in which it would be appropriate to license a sex establishment. Accordingly, the appropriate number of sex establishments for each and every locality within Tower Hamlets is zero.

As previously stated in the policy the Council will treat each application on its own merits however applicants should be aware that the Council will take into consideration the location of the proposed premises and its proximity to:

- residential accommodation,
- schools,
- premises used by children and vulnerable persons
- youth, community & leisure centres,
- religious centres and public places of worship
- access routes to and from premises listed above
- existing licensed premises in the vicinity

### **Impact**

In considering applications for the grant of new or variation applications the Council will assess the likelihood of a grant causing impacts, particularly on the local community.

The Council will take the following matters into account:

- the type of activity
- the duration of the proposed licence
- the proposed hours of operation
- the layout and condition of the premises
- the use of other premises in the vicinity
- the character and locality of the area
- the applicant's previous knowledge and experience
- the applicant's ability to minimise the impact of their business on local residents and businesses
- any evidence of the operation of existing /previous licences held by the applicant

- any reports about the applicant and management of the premises received from residents, Council officers or the police
- the ability of the proposed management structure to deliver compliance with licensing requirements, policies on staff training and the welfare of performers
- crime and disorder issues
- cumulative impact of licensed premises, including hours of operation
- the nature and concerns of local residents
- any evidence of complaints about noise or disturbance caused by premises
- planning permission and planning policy considerations

In considering applications for renewal the Council will take into account

- the applicant's ability to minimise the impact of their business on local residents and businesses
- any reports about the licensee and management of the premises received from residents, Council officers or the police
- whether appropriate measures have been agreed and put into place to mitigate any adverse impacts
- any evidence of complaints about noise or disturbance caused by premises

In considering applications for transfer the Council will take into account:

- the applicants previous knowledge and experience
- the applicants ability to minimise the impact of their business on local residents and businesses
- any evidence of the operation of existing /previous licences held by the applicant
- any reports about the applicant and management of the premises received from residents, Council officers or the police



- the ability of the proposed management structure to deliver compliance with licensing requirements, policies on staff training and the welfare of performers

## **Applicants**

Where appropriate the Council expects applicants to:

- demonstrate that they are qualified by experience
- have an understanding of general conditions
- propose a management structure which will deliver compliance with operating conditions for example through
- Management competence
- Presence
- Credible management structure
- enforcement of rules internally – training & monitoring
- a viable business plan covering door staff, CCTV
- policies for welfare of performers
- demonstrate that they can be relied upon to act in best interests of performers through remuneration, facilities, protection, physical and psychological welfare
- have a transparent charging scheme with freedom from solicitation
- a track record of management compliant premises or employ individuals with such a track record

New applicants may be invited for interview by the Licensing Officer and /or Police Officer prior to the application being referred to the Licensing Committee for determination.

Applications from anyone who intends to manage the premises on behalf of third party will be refused.

## **Premises appearance and layout**

The Council expects premises to:-

- have an external appearance which is in keeping with the locality
- prevent the display outside the premises of photographs or other images which may be construed as offensive to public decency

- adequate lighting to allow monitoring of all public areas
- surveillance by CCTV
- surveillance by CCTV of all private booths

## **Conditions**

The council will prescribe, and from time to time revise, standard conditions which will apply generally to licences that the council will grant or renew.

Through standard conditions the council seeks to ensure that sexual entertainment venues are well managed and supervised, restrict the sexual entertainment activities and the manner in which they are permitted to be provided, protect performers, and control the impact of the venue and its customers in relation to its locality.

Specifically, standard conditions could include measures which are found in the appendix of this policy.

## **The Application Process**

### **Making a new, renewal, transfer or variation application**

The Act requires the Council to refuse all application if the applicant:

- Is under the age of 18 or
- Has had their licence revoked in the last 12 months or
- Is not resident in the UK, or has not been a UK resident for the last 6months  
or
- Has been refused an application in the last 12 months or
- Is a corporate body which in not incorporated in the UK

Applications forms and details of current fee levels are available:

- on the Council's website ([www.towerhamlets .gov.uk](http://www.towerhamlets.gov.uk))
- from the Licensing Team on 020 7364 5008
- by email to [licensing@towerhamlets .gov.uk](mailto:licensing@towerhamlets.gov.uk)

The Council prefers to receive electronic applications and *offers a choice off payment options the details of which are contained in the application pack.*

The Council expects the premises to have planning consent for the intended use and hours of operation, or otherwise have lawful planning status before making an application for a new licence.

In order for the application to be valid the applicant must:

- Submit the completed application form
- Pay the application fee
- Submit a floor plan, drawn to scale showing the layout of the premises( new applications only)
- Submit a location plan (1;1250) showing the location of the premises(NB. plans will not be required for transfers nor renewal applications)
- 2 passport size photos of the applicant where the applicant is an individual rather than a limited company
- 2 passport size photos of the manager if applicant is a limited company(NB: photos will only be required if there has been a change of applicant or manager since the last application)
- Display an A4 notice at the proposed premises for 21 days following the date that the completed application is submitted setting out the application details. The notice must be in a prominent position so that it can be easily read by passers-by. A notice template will be provided with the application form.
- publish a notice on at least one occasion in a local newspaper, during the period of ten working days starting on the day the application was given Council. The advert can be any size or colour but must be readable.

Applicants who wish to advertise the application in another local newspaper are advised to contact the Licensing Team beforehand, to confirm that it is acceptable.

On receipt of a valid application the Council will consult:

- The Police
- The Fire Brigade
- Building Control
- Health and Safety
- Ward Councillors

For new and variation applications the Council will also consult:

- Development Control Team
- Local residents living within 50m of the premises

Authorised Officers from the Council, Fire Brigade and Police may choose to inspect the premises and require works to be carried out to bring the premises up to the required standard before the premises can be used for licensable activities.

The Council will not determine an application for a licence unless the applicant allows an authorised officer reasonable opportunity to enter the premises to make such examination and enquiries as may be necessary to determine the suitability of the applicant and the sex establishment.

### **Representations**

Anyone wishing to object to the application must submit a representation, in writing, within 28 days of the date that the valid application was received by the Council.

Representations can either be submitted via

- Our website: [www.towerhamlets.gov.uk](http://www.towerhamlets.gov.uk)
- Email to: [licensing@towerhamlets.gov.uk](mailto:licensing@towerhamlets.gov.uk)
- Post to: Consumer and Business Regulations, Licensing Team, 6<sup>th</sup> Floor, Mulberry Place, 5 Clove Crescent, E14 2BG.

A person making a representation must clearly state their name, address, and the grounds for objecting to the application and indicate whether they consent to have their name and address revealed to the applicant. Copies of representations will be made available to the applicant 14 days before the committee hearing.

The Council will not consider objections that are frivolous or vexatious or which relate to moral grounds (as these are outside the scope of the Act).

The Council prefers to receive electronic representations.

Late representations may be admissible at the discretion of the Council if there's sufficient reason to indicate that applicants will not be significantly prejudiced by the

decision to allow a late objection to be considered. In making such a decision the Council will take into account:

- The length of the delay
- The amount of time that the applicant has to consider the representation before the hearing date
- If other representations have been received before the deadline

### **Determining an application**

Applications with no representations will be approved under delegated authority to officers.

Applications with representations recommending that conditions be attached to the licence and which are acceptable to both the applicant and person making the representation can be approved under delegated authority to officers.

All other contested applications will be referred to the Licensing Committee for determination. The applicant, anyone making a representation and the ward Councillors will be notified the date, time and venue of the hearing and invited to attend to address the committee in person.

Applications can take up to 14 weeks to be determined. If an application is likely to take longer than 14 weeks to determine the Council will notify the applicant in writing before this deadline. Applications for sex establishment licenses are exempt from the tacit consent provisions of the EU Services Directive on the grounds of public interest and the legitimate interests of third parties.

The applicant will be notified in writing about the outcome of their application within 5 working days of the decision being made.

Sex Establishment licences are usually issued for 12 months, but can be issued for a shorter period if deemed appropriate.

In order to continue operating as a sex establishment the licence holder must make a renewal application prior to the expiry of the existing licence.

### **Appeals**

Any applicant who is aggrieved by a decision to refuse an application or by the imposition of any conditions can appeal to the Magistrates Court within 21 days of receiving the decision in writing.

### **Grounds for refusing an application**

1. The applicant is unsuitable to hold a licence by reason of having been convicted of any offence or for any other reason
2. That if the license were to be granted, renewed or transferred the business to which it relates would be managed by or carried on for the benefit of a person, other than the applicant, who would be refused the grant, renewal or transfer of such a license if he made the application himself
3. That the number of sex establishments in the relevant locality at the time the application is made is equal to or exceeds the number which the authority consider is appropriate for that locality
4. That the grant or renewal of the license would be inappropriate, having regard:-
  - a. to the character of the relevant locality
  - b. to the use to which any premises in the vicinity are put; or
  - c. to the layout, character or condition of the premises, vehicle, vessel or stall in respect of which the application is made.

## **Transitional Arrangements**

Broadly speaking, those existing sexual entertainment venues (lap dancing clubs etc) with a premises licence under the Licensing Act 2003, under which it is lawful to provide such entertainment, will continue to be able to operate for one year after the Council adopts the 2009 Act provisions or, if later, the determination of any application submitted during that year.

The 'transitional period' will last for 12-months beginning with the date that the Council resolves that Schedule 3 as amended by the 2009 Act will come into force in their area ('the 1st appointed day'). Six months following the 1st appointed day will be known as the '2nd appointed day' and the day on which the transitional period ends will be known as the '3rd appointed day'

### **Existing Operators**

To allow time to comply with the new regime, existing operators, who, immediately before the 1st appointed day, have a 2003 Act licence and lawfully use premises as a sexual entertainment venue under that licence or are undertaking preparatory work to use the venue in that way will be allowed to continue to provide relevant entertainment until the 3rd appointed day or the determination of any application they have submitted before that time (including any appeal against the refusal to grant a licence), whichever is later

For the purposes of the Transition a "2003 Act Licence" means a premises licence or club premises certificate under the Licensing Act 2003 under which it is lawful to provide relevant entertainment.

"Preparatory work" refers to work carried out by an operator, such as a refurbishment or refit, in order that they can use the premises as a sexual entertainment venue in the future. The operator will have been granted a 2003 Act licence before the 1<sup>st</sup> appointed day but will not have used the premises as a sexual entertainment venue by that date. It is likely that such operators will be known to the Council. However, where a dispute arises between the Council and

a licence-holder over whether the licence-holder qualifies as an existing operator by virtue of this provision the Council will need to seek evidence from the licence-holder to demonstrate that they clearly intended to operate a sexual entertainment venue in the future and work had been done to achieve this end.

For the purposes of the Transition a “2003 Act Licence” means a premises licence or club premises certificate under the Licensing Act 2003 under which it is lawful to provide relevant entertainment.

## **Appointed Days**

### **1st Appointed Day**

The day on which the Sexual Entertainment Venue regime comes into force in the Borough and the beginning of the transitional period (1<sup>st</sup> June 2014)

### **2nd Appointed Day**

The day 6 months after the 1st appointed day (1st December 2014)

### **3rd Appointed Day**

The day 6 months after the 2nd appointed day and the end of the transitional period (1<sup>st</sup> June 2015)

## **New Applications**

New applicants are people who wish to use premises as a sexual entertainment venue after the 1st appointed day but do not already have a premises licence or club premises certificate to operate as such under the 2003 Act or do have such a licence but have not taken any steps towards operating as such. After the 1st appointed day new applicants will not be able to operate as a sexual entertainment venue until they have been granted a sexual entertainment venue licence

## **Determining Applications Received On or Before the 2nd Appointed Day**



Applicants will be able to submit their application for a sexual entertainment venue from the 1st appointed day onwards.

As the Council is able to refuse applications having regard to the number of sex establishments they consider appropriate for a particular locality, all applications made on or after the 1<sup>st</sup> appointed day but on or before the 2nd appointed day shall be considered together. This will ensure that applicants are given sufficient time to submit their application and all applications received on or before the 2nd appointed day are considered on their individual merit and not on a first come first serve basis.

No applications shall be determined before the 2nd appointed day. After the 2nd appointed day the appropriate authority shall decide what if any licences should be granted. If a new applicant is granted a licence it will take effect immediately. If an existing operator is granted a licence, it will not take effect until the 3rd appointed day, up to which point they will be allowed to continue to operate under their existing premises licence or club premises certificate.

### **Determining Applications Received After the 2nd Appointed Day**

Applications made after the 2nd appointed day shall be considered when they are made but only once all applications made on or before that date have been determined. However, reference to determination here does not include references to the determination of any appeal against the refusal of a licence.

As with applications received on or before the 2nd appointed day, licences granted to new applicants shall take effect immediately and licences granted to existing operators shall take effect from the 3rd appointed day or, if later, the date the application is determined.

### **Outstanding Applications**

The Council will attempt where possible to determine outstanding applications made under the 2003 Act, which include an application for the provision of

relevant entertainment, before the date that Schedule 3 as amended by the 2009 Act comes into force in their area.

Where it has not been possible to determine application before the 1st appointed day, applicants will need to submit an application for a sex establishment licence as set out in Schedule 3 if they wish to provide relevant entertainment. From the 1st appointed day onwards outstanding applicants shall be dealt with as though they are new applicants

### **Additional information and advice**

Please contact:

Consumer and Business Regulations  
Licensing Team  
6<sup>th</sup> Floor,  
Mulberry Place,  
5 Clove Crescent,  
E14 2BG.  
[licensing@towerhamlets.gov.uk](mailto:licensing@towerhamlets.gov.uk)  
020 7364 5008